

CHAPTER 11

ACCESSIBILITY AMENDMENT

SECTION 1101 GENERAL

1101.1 Scope. The provisions of this chapter shall control the design and construction of facilities for accessibility to physically disabled persons.

1101.2 Design. Buildings and facilities shall be designed and constructed to be *accessible* in accordance with this code and ICC A117.1.

1101.2.1 Alternate methods. The application of Section 104.11 to this chapter shall be limited to the extent that alternate methods of construction, designs or technologies shall provide substantially equivalent or greater accessibility. Where approved by the building official, the provisions of the Fair Housing Act Amendments of 1988 may be considered as an alternate method to the criteria outlined in ICC A117.1 as it relates to covered multifamily dwellings.

ORS 447.220 and 447.231 are not a part of this code but are reproduced here for the reader's convenience:

447.220 Purpose. It is the purpose of ORS 447.210 to 447.280 to make affected buildings, including but not limited to commercial facilities, public accommodations, private entities, private membership clubs and churches, in the state accessible to and usable by persons with disabilities, as provided in the Americans with Disabilities Act, and to make covered multifamily dwellings in the state accessible to and usable by all persons with disabilities, as provided in the Fair Housing Act. In requiring that buildings and facilities be usable by persons with disabilities, it is not the intention of the Legislative Assembly to require that items of personal convenience such as rest rooms, telephones and drinking fountains be provided for members of the public who have disabilities if they are not otherwise provided for members of the public who do not have disabilities. However, pursuant to the Americans with Disabilities Act, the Director of the Department of Consumer and Business Services may provide greater protection to individuals with disabilities by adopting more stringent standards than prescribed by the Americans with Disabilities Act.

447.231 Rules to eliminate architectural barriers. Notwithstanding any other provision of law and the authority of any board within the Department of Consumer and Business Services, the Director of the Department of Consumer and Business Services shall adopt rules to conform the state building code to the Americans with Disabilities Act and the Fair Housing Act and the regulations adopted thereunder. In addition, the director shall adopt rules to conform the state building code to the provisions of ORS 447.210 to 447.280, to the extent to which any statute is stricter than the Americans with Disabilities Act or the Fair Housing Act.

1101.2.2 Amendments to ICC A117.1. The provisions of this section shall be considered amendments to ICC A117.1.

1101.2.2.1 Elevators – Section 407 of ICC A117.1. Section 407 of ICC A117.1 is not adopted. Elevators are

expressly regulated through the *Oregon Elevator Specialty Code*.

1101.2.2.2 Limited-Use/Limited-Application Elevators (LULA) – Section 408 of ICC A117.1. Section 408 of ICC A117.1 is not adopted. LULAs are expressly regulated through the *Oregon Elevator Specialty Code*.

1101.2.2.3 Private Residence Elevators – Section 409 of ICC A117.1. Section 409 of ICC A117.1 is not adopted. Private residence elevators are expressly regulated through the *Oregon Elevator Specialty Code*.

1101.2.2.4 Platform Lifts – Section 410 of ICC A117.1. Section 410 of ICC A117.1 is not adopted. Platform lifts are expressly regulated through the *Oregon Elevator Specialty Code*.

1101.2.2.5 Door Opening Force – Section 404.2.8 of ICC A117.1. Section 404.2.8 of ICC A117.1 is deleted in its entirety and replaced with the following: The opening force of doors along an accessible route shall be as follows:

1. Exterior doors: 8½ pounds-force (lbf) (37.8 N).
2. Interior doors: 5 pounds-force (lbf) (22.2 N).
3. Stairway doors at pressurized stair enclosures: 15 pounds (6.8 kg) at exterior doors.
4. Where environmental conditions require greater closing pressure, power-operated doors shall be used within the accessible route.
5. Fire doors shall have the minimum force necessary to close and latch the door.

1101.2.2.6 Detectable Warnings at Raised Marked Crossings – Section 406.12 of ICC A117.1. Section 406.12 of ICC A117.1 is deleted in its entirety.

1101.2.2.7 Vehicle Space Width – Section 502.1 of ICC A117.1. Section 502.1 of ICC A117.1 is deleted in its entirety and replaced with the following: Car and van parking spaces shall be 108 inches (2743.2 mm) minimum in width.

1101.2.2.8 Access Aisle Width – Section 502.4.2 of ICC A117.1. Section 502.4.2 of ICC A117.1 is deleted in its entirety and replaced with the following: Access aisles serving car parking spaces shall be 72 inches (1828.8 mm) minimum in width. Access aisles serving van parking spaces shall be 96 inches (2438.39 mm) minimum in width.

1101.3 Waivers and modifications. Waivers and modifications shall be in accordance with ORS 447.250.

ORS 447.250 is not a part of this code but are reproduced here for the reader's convenience:

447.250 Waivers or modifications of standards and specifications; appeals board; procedures; fees.

(1) When a person or governmental entity undertaking the construction, renovation, alteration or modification of an affected building or its related facilities determines that a particular standard or specification exceeds the standards or specifications imposed by the Americans with Disabilities Act and the Fair Housing Act, and that full compliance with the standard or specification is impractical in that it would defeat the purpose of the project proposed or in process, it may apply to the appeals board having jurisdiction over the project for a waiver or modification of such standard or specification, setting forth the reasons for its determination and a proposal for the work complying with the particular standard or specification to the maximum extent that it considers practical.

(2) (a) For projects involving a state correctional facility as defined in ORS 421.005(2), or a local correctional facility, as defined in ORS 169.005(3), the appeals board referred to in subsection (1) of this section is the Building Codes Structures Board established under ORS 455.132.

(b) For all other projects, the appeals board referred to in subsection (1) of this section is the appeals board established under ORS 455.020(4) by the municipality having jurisdiction over the project.

(3) The appeals board shall thereupon investigate the application. The board in its investigation shall be required to seek the advice of the Oregon Disabilities Commission or its designee in dealing with architectural barrier waivers. If the appeals board finds that the proposal submitted with the application would constitute a substantial compliance with, or an acceptable alternative to, the particular standard or specification in view of the objectives of ORS 447.210 to 447.280, the waiver shall be granted. If the board finds otherwise, the application shall be promptly denied with notice to the requesting person or governmental entity of the denial.

(4) The findings of the appeals board shall include the estimated building costs and the additional cost of construction to conform to the requirements of ORS 447.210 to 447.280 over the cost of a nonconforming feature or any other special reason or circumstance that, in the judgment of the board, justifies the decision.

(5) Any person aggrieved by the final decision of an appeals board may within 30 days of the decision appeal to the Director of the Department of Consumer and Business Services. In the case where no appeals board has been created the director shall have original jurisdiction of an application for a waiver. The applicant for a waiver or an appeal shall submit a fee of \$20 payable to the director with the request for waiver or appeal. In determining an appeal or an original application, the procedures and standards of subsections (1) to (4) of this section shall apply to the director.

**SECTION 1102
DEFINITIONS**

1102.1 Definitions. The following words and terms shall, for the purposes of this chapter and as used elsewhere in the code, have the meanings shown herein:

ACCESSIBLE. A *site*, building, *facility* or portion thereof that complies with this chapter.

ACCESSIBLE MEANS OF EGRESS. A path of travel, usable by a mobility-impaired person, that leads to a public way.

ACCESSIBLE ROUTE. A continuous, unobstructed path that complies with this chapter.

ACCESSIBLE SPACE. A space that complies with this code.

ACCESSIBLE UNIT. A *dwelling unit* or *sleeping unit* that complies with this code and the provisions for *Accessible units* in ICC A117.1.

ADDITION. An expansion, extension or increase in the gross floor area of a building or facility.

AFFECTED BUILDINGS. See ORS 447.210(1).

ORS 447.210(1) is not a part of this code but is reproduced here for the reader's convenience:

447.210(1) "Affected buildings" includes any place of public accommodations and commercial facilities designed, constructed and altered in compliance with the accessibility standards established by the Americans with Disabilities Act. "Affected buildings" also includes any government building that is subject to Title II of the Americans with Disabilities Act. "Affected buildings" also includes private entities, private membership clubs and churches that have more than one floor level and more than 4,000 square feet in ground area or that are more than 20 feet in height, measured from the top surface of the lowest flooring to the highest interior overhead finish of the building.

CIRCULATION PATH. An exterior or interior way of passage from one place to another for pedestrians.

CLUSTERED MAILBOXES. Clustered mailbox units, which are also known as Centralized Box Units or CBU's, are free-standing mailbox units with multiple locked mailboxes, along with parcel lockers and a slot for mail collection.

COMMON USE. Interior or exterior circulation paths, rooms, spaces or elements that are not for public use and are made available for the shared use of two or more people.

COVERED MULTIFAMILY DWELLINGS. See ORS 447.210(5).

ORS 447.210(5) is not a part of this code but is reproduced here for the reader's convenience:

447.210(5) "Covered multifamily dwellings" means buildings consisting of four or more dwelling units if such buildings have one or more elevators, and ground floor dwelling units in other buildings consisting of four or more dwelling units. Dwelling units within a single structure separated by firewalls do not constitute separate buildings.

As part of this code, covered multifamily dwellings, are only applicable to covered multifamily dwellings designed and constructed for first occupancy after March 13, 1991, or where the last building permit or renewal thereof was issued on or before June 15, 1990. For the purposes of this section, "first occupancy" means "a building that has never before been used for any purpose."

DETECTABLE WARNING. A standardized surface feature built in or applied to walking surfaces or other elements to warn visually impaired persons of hazards on a *circulation path*.

DWELLING UNIT OR SLEEPING UNIT, MULTISTORY. See definition for "*Multistory unit*."

DWELLING UNIT OR SLEEPING UNIT, TYPE A. See definition for “*Type A unit*.”

DWELLING UNIT OR SLEEPING UNIT, TYPE B. See definition for “*Type B unit*.”

ELEMENT. An architectural or mechanical component of a building, facility, space or site such as a telephone, curb ramp, door, drinking fountain, seating, clustered mailboxes or water closet.

EMPLOYEE WORK AREA. All or any portion of a space used only by employees and only for work. *Corridors*, toilet rooms, kitchenettes and break rooms are not *employee work areas*.

FACILITY. All or any portion of buildings, structures, *site* improvements, elements and pedestrian or vehicular routes located on a site.

HISTORIC BUILDING. A structure, in whole or in part, that is listed on or is eligible for listing on the National Register of Historic Places, established and maintained under the National Historic Preservation Act of 1966 (P.L. 89-665), or if the National Register of Historic Places ceases accepting nominations, is approved for listing on an Oregon register of historic places, or is a locally designated landmark protected by ordinance.

INTENDED TO BE OCCUPIED AS A RESIDENCE. This refers to a *dwelling unit* or *sleeping unit* that can or will be used all or part of the time as the occupant's place of abode.

MEZZANINE OR MEZZANINE FLOOR. That portion of a story that is an intermediate floor level placed within the story and having occupiable space above and below its floor.

MULTILEVEL ASSEMBLY SEATING. Seating that is arranged in distinct levels where each level is comprised of either multiple rows, or a single row of box seats accessed from a separate level.

MULTISTORY UNIT. A *dwelling unit* or *sleeping unit* with *habitable space* located on more than one *story*.

OVERHEAD FINISH OF A BUILDING. The lowest point of the interior finished ceiling surface on the uppermost floor level required to be accessible, but in no case shall this point be lower than the highest point used to measure the clear height for an accessible route on that level.

PRIMARY FUNCTION. A major function for which the facility is intended, including all customer service areas and employee work areas, but does not include mechanical rooms, boiler rooms, supply storage rooms, floors or portions of a floor not customarily occupied, observation galleries used primarily for security purposes, employee lounges or locker rooms, janitorial closets, entrances, corridors, toilet facilities and bathing facilities, unless such areas are the major function of the facility.

PRIVATE ENTITIES. See ORS 447.210(10).

ORS 447.210(10) is not a part of this code but is reproduced here for the reader's convenience:

447.210(10) “Private entities” means privately owned entities offering examinations or courses related to applications, licensing, certifications or credentials for secondary or post-secondary education, professional or trade purposes.

PUBLIC ACCOMODATIONS. See ORS 447.210(11).

ORS 447.210(11) is not part of this code but is reproduced here for the reader's convenience:

447.210(11) “Public accommodations” means a facility whose operations affect commerce and fall within at least one of the following categories:

- (a) Places of lodging not including owner-occupied establishments renting fewer than six rooms;
- (b) Establishments serving food or drink;
- (c) Places of exhibition or entertainment;
- (d) Places of public gathering;
- (e) Sales or rental establishments;
- (f) Service establishments;
- (g) Public transportation terminals, depots or stations;
- (h) Places of public display or collection;
- (i) Places of recreation;
- (j) Places of education;
- (k) Social service center establishments;
- (l) Places of exercise or recreation.

PUBLIC ENTRANCE. An entrance that is not a *service entrance* or a *restricted entrance*.

PUBLIC USE. Interior or exterior rooms or spaces that are made available to the general public. Public use may be provided at a building or facility that is privately or publicly owned.

PUBLIC-USE AREAS. Interior or exterior rooms or spaces that are made available to the general public.

RESTRICTED ENTRANCE. An entrance that is made available for *common use* on a controlled basis, but not public use, and that is not a *service entrance*.

SELF-SERVICE STORAGE FACILITY. Real property designed and used for the purpose of renting or leasing individual storage spaces to customers for the purpose of storing and removing personal property on a self-service basis.

SERVICE ENTRANCE. An entrance intended primarily for delivery of goods or services.

SIGNAGE. Displayed verbal, symbolic, tactile or pictorial information.

SITE. A parcel of land bounded by a *lot line* or a designated portion of a public right-of-way.

SPACE. A definable area; e.g., room, toilet room, hall, assembly area, entry, storage room, alcove, courtyard or lobby.

TECHNICALLY INFEASIBLE. An alteration that has little likelihood of being accomplished because existing structural conditions would require removing or altering a load-bearing member that is an essential part of the structural frame, or because site constraints prohibit modification or addition of elements, spaces or features that are in full and strict compliance with the minimum requirements for new construction and are necessary to provide accessibility.

TYPE A UNIT. A *dwelling unit* or *sleeping unit* designed and constructed for accessibility in accordance with this code and the provisions for *Type A units* in ICC A117.1.

TYPE B UNIT. A *dwelling unit* or *sleeping unit* designed and constructed for accessibility in accordance with this code and the provisions for *Type B units* in ICC A117.1, consistent with the design and construction requirements of the federal Fair Housing Act.

WHEELCHAIR SPACE. A space for a single wheelchair and its occupant.

SECTION 1103 SCOPING REQUIREMENTS

1103.1 Where required. *Sites*, buildings, *structures*, *facilities*, elements and spaces, temporary or permanent, shall be *accessible* to persons with physical disabilities.

1103.2 General exceptions. *Sites*, buildings, *structures*, *facilities*, elements and spaces shall be exempt from this chapter to the extent specified in this section.

1103.2.1 Specific requirements. *Accessibility* is not required in buildings and *facilities*, or portions thereof, to the extent permitted by Sections 1104 through 1110.

1103.2.2 Existing buildings. Existing buildings shall comply with Section 3411.

1103.2.3 Employee work areas. Spaces and elements within *employee work areas* shall only be required to comply with Sections 907.5.2.3.2, 1007 and 1104.3.1 and shall be designed and constructed so that individuals with disabilities can approach, enter and exit the work area. Work areas, or portions of work areas, other than raised courtroom stations, that are less than 300 square feet (30 m²) in area and elevated 7 inches (178 mm) or more above the ground or finish floor where the elevation is essential to the function of the space shall be exempt from all requirements.

1103.2.4 Detached dwellings. Detached one- and two-family *dwellings* and accessory structures, and their associated *sites* and facilities, are not required to be *accessible*.

1103.2.5 Utility buildings. Occupancies in Group U are exempt from the requirements of this chapter other than the following:

1. In agricultural buildings, access is required to paved work areas and areas open to the general public.

2. Private garages or carports that contain required *accessible* parking.

1103.2.6 Construction sites. Structures, *sites* and equipment directly associated with the actual processes of construction including, but not limited to, scaffolding, bridging, materials hoists, materials storage or construction trailers are not required to be *accessible*.

1103.2.7 Raised areas. Raised areas used primarily for purposes of security, life safety or fire safety including, but not limited to, observation galleries, prison guard towers, fire towers or lifeguard stands, are not required to be *accessible* or to be served by an *accessible route*.

1103.2.8 Limited access spaces. Nonoccupiable spaces accessed only by ladders, catwalks, crawl spaces, freight elevators or very narrow passageways are not required to be *accessible*.

1103.2.9 Equipment spaces. Spaces frequented only by personnel for maintenance, repair or monitoring of equipment are not required to be *accessible*. Such spaces include, but are not limited to, elevator pits, elevator *pent-houses*, mechanical, electrical or communications equipment rooms, piping or equipment catwalks, water or sewage treatment pump rooms and stations, electric substations and transformer vaults, and highway and tunnel utility facilities.

1103.2.10 Single-occupant structures. Single-occupant structures accessed only by passageways below grade or elevated above grade including, but not limited to, toll booths that are accessed only by underground tunnels, are not required to be *accessible*.

1103.2.11 Residential Group R-1. Buildings of Group R-1 containing not more than five *sleeping units* for rent or hire that are also occupied as the residence of the proprietor are not required to be *accessible*.

1103.2.12 Day care facilities. Where a day care facility (Groups A-3, E, I-4 and R-3) is part of a *dwelling unit*, only the portion of the structure utilized for the day care facility is required to be *accessible*.

1103.2.13 Live/work units. In live/work units constructed in accordance with Section 419, the portion of the unit utilized for nonresidential use is required to be *accessible*. The residential portion of the live/work unit is required to be evaluated separately in accordance with Sections 1107.6.2 and 1107.7.

1103.2.14 Detention and correctional facilities. In detention and correctional facilities, *common use* areas that are used only by inmates or detainees and security personnel, and that do not serve holding cells or housing cells required to be *accessible*, are not required to be *accessible* or to be served by an *accessible route*.

1103.2.15 Walk-in coolers and freezers. Walk-in coolers and freezers intended for employee use only are not required to be *accessible*.

1103.2.16 Private membership clubs and churches. Private membership clubs and churches that have more than one floor level and more than 4,000 square feet (371.6 m²) in

ground area or more than one floor level and more than 20 feet (6096 mm) in height, measured from the top surface of the lowest flooring to the highest interior overhead finish of the building, are required to be accessible. (ORS 447.210[1].)

SECTION 1104 ACCESSIBLE ROUTE

1104.1 Site arrival points. *Accessible routes* within the site shall be provided from public transportation stops; accessible parking; *accessible* passenger loading zones; and public streets or sidewalks to the *accessible* building entrance served.

Exception: Other than in buildings or facilities containing or serving *Type B units*, an *accessible route* shall not be required between *site* arrival points and the building or facility entrance if the only means of access between them is a vehicular way not providing for pedestrian access.

1104.2 Within a site. At least one *accessible route* shall connect *accessible* buildings, *accessible* facilities, *accessible* elements and *accessible* spaces that are on the same *site*.

Exception: An *accessible route* is not required between *accessible* buildings, *accessible* facilities, *accessible* elements and *accessible* spaces that have, as the only means of access between them, a vehicular way not providing for pedestrian access.

1104.3 Connected spaces. When a building or portion of a building is required to be *accessible*, an *accessible route* shall be provided to each portion of the building, to *accessible* building entrances connecting *accessible pedestrian walkways* and the public way.

Exceptions:

1. In assembly areas with fixed seating, an *accessible route* shall not be required to serve levels where wheelchair spaces are not provided.
2. In Group I-2 facilities, doors to *sleeping units* shall be exempted from the requirements for maneuvering clearance at the room side provided the door is a minimum of 44 inches (1118 mm) in width.

1104.3.1 Employee work areas. *Common use circulation paths* within *employee work areas* shall be *accessible routes*.

Exceptions:

1. *Common use circulation paths*, located within *employee work areas* that are less than 300 square feet (27.9 m²) in size and defined by permanently installed partitions, counters, casework or furnishings, shall not be required to be *accessible routes*.
2. *Common use circulation paths*, located within *employee work areas*, that are and integral component of equipment, shall not be required to be *accessible routes*.
3. *Common use circulation paths*, located within exterior *employee work areas* that are fully

exposed to the weather, shall not be required to be *accessible routes*.

1104.3.2 Press boxes. Press boxes in assembly areas shall be on an *accessible route*.

Exceptions:

1. An *accessible route* shall not be required to press boxes in *bleachers* that have points of entry at only one level, provided that the aggregate area of all press boxes is 500 square feet (46 m²) maximum.
2. An *accessible route* shall not be required to free-standing press boxes that are elevated above grade 12 feet (3660 mm) minimum provided that the aggregate area of all press boxes is 500 square feet (46 m²) maximum.

1104.4 Multilevel buildings and facilities. At least one *accessible route* shall connect each *accessible* level, including *mezzanines*, in multilevel buildings and facilities.

Exceptions:

1. An *accessible route* is not required to stories and *mezzanines* that have an aggregate area of not more than 3,000 square feet (278.7 m²) and are located above and below *accessible* levels. This exception shall not apply to:
 - 1.1. Multiple tenant facilities of Group M occupancies containing five or more tenant spaces;
 - 1.2. Levels containing offices of health care providers (Group B or I);
 - 1.3. Passenger transportation facilities and airports (Group A-3 or B);
 - 1.4. Government buildings covered by Title II of the Americans with Disabilities Act.
2. Levels that do not contain *accessible* elements or other spaces as determined by Section 1107 or 1108 are not required to be served by an *accessible route* from an *accessible* level.
3. In air traffic control towers, an *accessible route* is not required to serve the cab and the floor immediately below the cab.
4. Where a two-story building or facility has one *story* with an *occupant load* of five or fewer persons that does not contain *public use* space, that *story* shall not be required to be connected by an *accessible route* to the *story* above or below.
5. Vertical access to elevated employee work stations within a courtroom is not required at the time of initial construction, provided a *ramp*, lift or elevator complying with ICC A117.1 can be installed without requiring reconfiguration or extension of the courtroom or extension of the electrical system.

1104.5 Location. *Accessible routes* shall coincide with or be located in the same area as a general *circulation path*. Where the *circulation path* is interior, the *accessible route* shall also be interior. Where only one *accessible route* is provided, the

accessible route shall not pass through kitchens, storage rooms, restrooms, closets or similar spaces.

Exceptions:

1. *Accessible routes* from parking garages contained within and serving *Type B units* are not required to be interior.
2. A single *accessible route* is permitted to pass through a kitchen or storage room in an *Accessible unit, Type A unit* or *Type B unit*.

1104.6 Security barriers. Security barriers including, but not limited to, security bollards and security check points shall not obstruct a required *accessible route* or *accessible means of egress*.

Exception: Where security barriers incorporate elements that cannot comply with these requirements, such as certain metal detectors, fluoroscopes or other similar devices, the *accessible route* shall be permitted to be provided adjacent to security screening devices. The *accessible route* shall permit persons with disabilities passing around security barriers to maintain visual contact with their personal items to the same extent provided others passing through the security barrier.

**SECTION 1105
ACCESSIBLE ENTRANCES**

1105.1 Public entrances. In addition to *accessible* entrances required by Sections 1105.1.1 through 1105.1.6, at least 60 percent of all *public entrances* shall be *accessible*.

Exceptions:

1. An *accessible* entrance is not required to areas not required to be *accessible*.
2. Loading and *service entrances* that are not the only entrance to a tenant space.

1105.1.1 Parking garage entrances. Where provided, direct access for pedestrians from parking structures to buildings or facility entrances shall be *accessible*.

1105.1.2 Entrances from tunnels or elevated walkways. Where direct access is provided for pedestrians from a pedestrian tunnel or elevated walkway to a building or facility, at least one entrance to the building or facility from each tunnel or walkway shall be *accessible*.

1105.1.3 Restricted entrances. Where *restricted entrances* are provided to a building or facility, at least one *restricted entrance* to the building or facility shall be *accessible*.

1105.1.4 Entrances for inmates or detainees. Where entrances used only by inmates or detainees and security personnel are provided at judicial facilities, detention facilities or correctional facilities, at least one such entrance shall be *accessible*.

1105.1.5 Service entrances. If a *service entrance* is the only entrance to a building or a tenant space in a facility, that entrance shall be *accessible*.

1105.1.6 Tenant spaces, dwelling units and sleeping units. At least one *accessible* entrance shall be provided to each tenant, *dwelling unit* and *sleeping unit* in a facility.

Exceptions:

1. An *accessible* entrance is not required to tenants that are not required to be *accessible*.
2. An *accessible* entrance is not required to *dwelling units* and *sleeping units* that are not required to be *Accessible units, Type A units* or *Type B units*.

**SECTION 1106
PARKING AND PASSENGER LOADING FACILITIES**

1106.1 Required. Where parking is provided, *accessible* parking spaces shall be provided in compliance with Table 1106.1, except as required by Sections 1106.2 through 1106.4. Where more than one parking facility is provided on a site, the number of parking spaces required to be *accessible* shall be calculated separately for each parking facility.

Exception: This section does not apply to parking spaces used exclusively for buses, trucks, other delivery vehicles, law enforcement vehicles or vehicular impound and motor pools where lots accessed by the public are provided with an *accessible* passenger loading zone.

**TABLE 1106.1
ACCESSIBLE PARKING SPACES**

TOTAL PARKING SPACES PROVIDED	MINIMUM NUMBER OF ACCESSIBLE SPACES	NUMBER OF VAN ACCESSIBLE SPACES	"WHEELCHAIR USER ONLY" SPACES
1 to 25	1	1	—
26 to 50	2	1	—
51 to 75	3	1	—
76 to 100	4	1	—
101 to 150	5	—	1
151 to 200	6	—	1
201 to 300	7	—	2
301 to 400	8	—	2
401 to 500	9	—	2
501 to 1,000	2% of total	—	1 in every 6 accessible spaces or portion thereof
1,001 and over	20, plus one for each 100, or fraction thereof, over 1,000	—	1 in every 6 accessible spaces or portion thereof

ORS 447.233(5) through (7) are not a part of this code but are reproduced here for the reader's convenience:

447.233 Accessible parking space requirements; inspection of spaces; remedy for violation.

(5) The director is authorized to inspect parking spaces and facilities and buildings subject to the provisions of this section, and to do whatever is necessary to enforce the requirements, including the maintenance requirements, of this section. Municipalities and counties may administer and enforce the requirements of this section in the manner provided under ORS 455.150 for administration and enforcement of specialty codes. All plans for parking spaces subject to the provisions of this section must be approved by the director prior to the creation of the spaces.

(6) Requirements adopted under this section shall not apply to long-term parking facilities at the Portland International Airport.

(7) Any reported violation of this section shall be investigated by the administrative authority. The administrative authority shall make a final decision and order correction, if necessary, within 30 days of notification. Any aggrieved person may appeal within 30 days of the decision by the administrative authority to the appropriate municipal appeals board or, at the option of the local jurisdiction, directly to the Building Codes Structures Board established under ORS 455.132. The appeal shall be acted upon within 60 days of filing. The decision of the municipal appeals board may be appealed to the board. The board shall act on the appeal within 60 days of filing. All appeals to the board shall be filed in accordance with ORS 455.690.

1106.2 Groups R-2 and R-3. At least 2 percent, but not less than one, of each type of parking space provided for occupancies in Groups R-2 and R-3, which are required to have *Accessible, Type A* or *Type B dwelling* or *sleeping units*, shall be *accessible*. Where parking is provided within or beneath a building, *accessible* parking spaces shall also be provided within or beneath the building.

1106.3 Hospital outpatient facilities. At least 10 percent, but not less than one, of patient and visitor parking spaces provided to serve hospital outpatient facilities shall be *accessible*.

1106.4 Rehabilitation facilities and outpatient physical therapy facilities. At least 20 percent, but not less than one, of the portion of patient and visitor parking spaces serving rehabilitation facilities specializing in treating conditions that affect mobility and outpatient physical therapy facilities shall be *accessible*.

1106.5 Van spaces. For every six or fraction of six *accessible* parking spaces, at least one shall be a van-accessible parking space. Where five or more parking spaces are designated *accessible*, any space that is designated as van accessible shall be reserved for wheelchair users.

Exception: In Group R-2 and R-3 occupancies, van-accessible spaces located within private garages shall be permitted to have vehicular routes, entrances, parking spaces and access aisles with a minimum vertical clearance of 7 feet (2134 mm).

1106.6 Location. *Accessible* parking spaces shall be located on the shortest practical *accessible route* of travel from adjacent parking to an *accessible* building entrance. In parking facilities that do not serve a particular building, *accessible* parking spaces shall be located on the shortest route to an

accessible pedestrian entrance to the parking facility. Where buildings have multiple accessible entrances with adjacent parking, *accessible* parking spaces shall be dispersed and located near the *accessible* entrances.

Exceptions:

1. In multilevel parking structures, van-accessible parking spaces are permitted on one level.
2. *Accessible* parking spaces shall be permitted to be located in different parking facilities if substantially equivalent or greater accessibility is provided in terms of distance from an *accessible* entrance or entrances, parking fee and user convenience.

1106.7 Parking spaces

1106.7.1 General. Accessible car and van parking spaces shall comply with Figures 2 through 6, and 10; and Section 502 of ICC A117.1. The access aisle adjacent to the disabled parking space shall be on the passenger side of the vehicle unless the aisle serves two vehicles.

1106.7.2 Identification. In addition to the requirements of Section 502.7 of ICC A117.1, when the van accessible space meets the provisions of Section 1106.5 the space shall also have a sign designating "wheelchair user only." Such signs shall be 60 inches (1525 mm) minimum above the floor of the parking space, measured to the bottom of the sign. See Figures 1 through 10 for sign configurations.

1106.8 Passenger loading zones. Passenger loading zones shall be designed and constructed in accordance with ICC A117.1.

1106.8.1 Continuous loading zones. Where passenger loading zones are provided, one passenger loading zone in every continuous 100 linear feet (30.4 m) maximum of loading zone space shall be *accessible*.

1106.8.2 Medical facilities. A passenger loading zone shall be provided at an *accessible* entrance to licensed medical and long-term care facilities where people receive physical or medical treatment or care and where the period of stay exceeds 24 hours.

1106.8.2.1 Group I-2. In Group I-2 healthcare occupancies, at least one accessible entry shall be under shelter. Every such entry shall include a passenger loading zone.

1106.8.3 Valet parking. A passenger loading zone shall be provided at valet parking services.

1106.8.4 Mechanical access parking garages. Mechanical access parking garages shall provide at least one passenger loading zone at vehicle drop-off and vehicle pick-up areas.

**SECTION 1107
DWELLING UNITS AND SLEEPING UNITS**

1107.1 General. In addition to the other requirements of this chapter, occupancies having *dwelling units* or *sleeping units* shall be provided with *accessible* features in accordance with this section.

1107.2 Design. *Dwelling units* and *sleeping units* that are required to be *Accessible units*, *Type A units* and *Type B units* shall comply with the applicable portions of Chapter 10 of ICC A117.1. Units required to be *Type A units* are permitted to be designed and constructed as *Accessible units*. Units required to be *Type B units* are permitted to be designed and constructed as *Accessible units* or as *Type A units*.

1107.3 Accessible spaces. Rooms and spaces available to the general public or available for use by residents and serving *Accessible units*, *Type A units* or *Type B units* shall be *accessible*. *Accessible* spaces shall include toilet and bathing rooms, kitchen, living and dining areas and any exterior spaces, including patios, terraces and balconies.

Exceptions:

1. Recreational facilities in accordance with Section 1109.14.
2. In Group I-2 facilities, doors to *sleeping units* shall be exempted from the requirements for maneuvering clearance at the room side provided the door is a minimum of 44 inches (1118 mm) in width.

1107.4 Accessible route. At least one *accessible route* shall connect *accessible* building or facility entrances with the primary entrance of each *Accessible unit*, *Type A unit* and *Type B unit* within the building or facility and with those exterior and interior spaces and facilities that serve the units.

Exceptions:

1. If due to circumstances outside the control of the owner, either the slope of the finished ground level between *accessible* facilities and buildings exceeds one unit vertical in 12 units horizontal (1:12), or where physical barriers or legal restrictions prevent the installation of an *accessible route*, a vehicular route with parking that complies with Section 1106 at each *public* or common use facility or building is permitted in place of the *accessible route*.
2. Exterior decks, patios or balconies that are part of *Type B units* and have impervious surfaces, and that are not more than 4 inches (102 mm) below the finished floor level of the adjacent interior space of the unit.

1107.5 Group I. *Accessible units* and *Type B units* shall be provided in Group I occupancies in accordance with Sections 1107.5.1 through 1107.5.5.

1107.5.1 Group I-1. *Accessible units* and *Type B units* shall be provided in Group I-1 occupancies in accordance with Sections 1107.5.1.1 and 1107.5.1.2.

1107.5.1.1 Accessible units. At least 4 percent, but not less than one, of the *dwelling units* and *sleeping units* shall be *Accessible units*.

1107.5.1.2 Type B units. In structures with four or more *dwelling units* or *sleeping units* intended to be occupied as a residence, every *dwelling unit* and *sleeping unit* intended to be occupied as a residence shall be a *Type B unit*.

Exception: The number of *Type B units* is permitted to be reduced in accordance with Section 1107.7.

1107.5.2 Group I-2 nursing homes. *Accessible units* and *Type B units* shall be provided in nursing homes of Group I-2 occupancies in accordance with Sections 1107.5.2.1 and 1107.5.2.2.

1107.5.2.1 Accessible units. At least 50 percent but not less than one of each type of the *dwelling units* and *sleeping units* shall be *Accessible units*.

1107.5.2.2 Type B units. In structures with four or more *dwelling units* or *sleeping units* intended to be occupied as a residence, every *dwelling unit* and *sleeping unit* intended to be occupied as a residence shall be a *Type B unit*.

Exception: The number of *Type B units* is permitted to be reduced in accordance with Section 1107.7.

1107.5.3 Group I-2 hospitals. *Accessible units* and *Type B units* shall be provided in general-purpose hospitals, psychiatric facilities, detoxification facilities and *residential care/assisted living facilities* of Group I-2 occupancies in accordance with Sections 1107.5.3.1 and 1107.5.3.2.

1107.5.3.1 Accessible units. At least 10 percent, but not less than one, of the *dwelling units* and *sleeping units* shall be *Accessible units*.

1107.5.3.2 Type B units. In structures with four or more *dwelling units* or *sleeping units* intended to be occupied as a residence, every *dwelling unit* and *sleeping unit* intended to be occupied as a residence shall be a *Type B unit*.

Exception: The number of *Type B units* is permitted to be reduced in accordance with Section 1107.7.

1107.5.4 Group I-2 rehabilitation facilities. In hospitals and rehabilitation facilities of Group I-2 occupancies which specialize in treating conditions that affect mobility, or units within either which specialize in treating conditions that affect mobility, 100 percent of the *dwelling units* and *sleeping units* shall be *Accessible units*.

1107.5.5 Group I-3. *Accessible units* shall be provided in Group I-3 occupancies in accordance with Sections 1107.5.5.1 through 1107.5.5.3.

1107.5.5.1 Group I-3 sleeping units. In Group I-3 occupancies, at least 2 percent, but not less than one, of the *dwelling units* and *sleeping units* shall be *Accessible units*.

1107.5.5.2 Special holding cells and special housing cells or rooms. In addition to the *Accessible units* required by Section 1107.5.5.1, where special holding cells or special housing cells or rooms are provided, at least one serving each purpose shall be an *Accessible unit*. Cells or rooms subject to this requirement include, but are not limited to, those used for purposes of orientation, protective custody, administrative or disciplinary detention or segregation, detoxification and medical isolation.

Exception: Cells or rooms specially designed without protrusions and that are used solely for purposes of suicide prevention shall not be required to include grab bars.

1107.5.5.3 Medical care facilities. Patient *sleeping units* or cells required to be *Accessible units* in medical care facilities shall be provided in addition to any medical isolation cells required to comply with Section 1107.5.5.2.

1107.6 Group R. *Accessible units, Type A units and Type B units* shall be provided in Group R occupancies in accordance with Sections 1107.6.1 through 1107.6.4.

1107.6.1 Group R-1. *Accessible units and Type B units* shall be provided in Group R- 1 occupancies in accordance with Sections 1107.6.1.1 and 1107.6.1.2.

1107.6.1.1 Accessible units. In Group R-1 occupancies, *Accessible dwelling units and sleeping units* shall be provided in accordance with Table 1107.6.1.1. All R- 1 units on a *site* shall be considered to determine the total number of *Accessible units*. *Accessible units* shall be dispersed among the various classes of units. Roll-in showers provided in *Accessible units* shall include a permanently mounted folding shower seat.

1107.6.1.2 Type B units. In structures with four or more *dwelling units or sleeping units intended to be occupied as a residence, every dwelling unit and sleeping unit intended to be occupied as a residence* shall be a *Type B unit*.

Exception: The number of *Type B units* is permitted to be reduced in accordance with Section 1107.7.

1107.6.2 Group R-2. *Accessible units, Type A units and Type B units* shall be provided in Group R-2 occupancies in accordance with Sections 1107.6.2.1 and 1107.6.2.2.

1107.6.2.1 Apartment houses, monasteries and convents. *Type A units and Type B units* shall be provided in apartment houses, monasteries and convents in accordance with Sections 1107.6.2.1.1 and 1107.6.2.1.2.

1107.6.2.1.1 Type A units. In Group R-2 occupancies containing more than 20 *dwelling units or sleeping units*, at least 2 percent but not less than one of the

units shall be a *Type A unit*. All Group R-2 units on a *site* shall be considered to determine the total number of units and the required number of *Type A units*. *Type A units* shall be dispersed among the various classes of units.

Exceptions:

1. The number of *Type A units* is permitted to be reduced in accordance with Section 1107.7.
2. *Existing structures* on a *site* shall not contribute to the total number of units on a *site*.

1107.6.2.1.2 Type B units. Where there are four or more *dwelling units or sleeping units intended to be occupied as a residence* in a single structure, every *dwelling unit and sleeping unit intended to be occupied as a residence* shall be a *Type B unit*.

Exception: The number of *Type B units* is permitted to be reduced in accordance with Section 1107.7.

1107.6.2.2 Group R-2 other than apartment houses, monasteries and convents. In Group R-2 occupancies, Other than apartment houses, monasteries and convents, *Accessible units and Type B units* shall be provided in accordance with Sections 1107.6.2.2.1 and 1107.6.2.2.2.

1107.6.2.2.1 Accessible units. *Accessible dwelling units and sleeping units* shall be provided in accordance with Table 1107.6.1.1.

1107.6.2.2.2 Type B units. Where there are four or more *dwelling units or sleeping units intended to be occupied as a residence* in a single structure, every *dwelling unit and every sleeping unit intended to be occupied as a residence* shall be a *Type B unit*.

Exception: The number of *Type B units* is permitted to be reduced in accordance with Section 1107.7.

**TABLE 1107.6.1.1
ACCESSIBLE DWELLING AND SLEEPING UNITS**

TOTAL NUMBER OF UNITS PROVIDED	MINIMUM REQUIRED NUMBER OF ACCESSIBLE UNITS WITHOUT ROLL-IN SHOWERS	MINIMUM REQUIRED NUMBER OF ACCESSIBLE UNITS WITH ROLL-IN SHOWERS	TOTAL NUMBER OF REQUIRED ACCESSIBLE UNITS
1 to 25	1	0	1
26 to 50	2	0	2
51 to 75	3	1	4
76 to 100	4	1	5
101 to 150	5	2	7
151 to 200	6	2	8
201 to 300	7	3	10
301 to 400	8	4	12
401 to 500	9	4	13
501 to 1,000	2% of total	1% of total	3% of total
Over 1,000	20, plus 1 for each 100, or fraction thereof, over 1,000	10 plus 1 for each 100, or fraction thereof, over 1,000	30 plus 2 for each 100, or fraction thereof, over 1,000

1107.6.3 Group R-3. In Group R-3 occupancies where there are four or more *dwelling units* or *sleeping units intended to be occupied as a residence* in a single structure, every *dwelling unit* and *sleeping unit intended to be occupied as a residence* shall be a *Type B unit*.

Exception: The number of *Type B units* is permitted to be reduced in accordance with Section 1107.7.

1107.6.4 Group R-4. *Accessible units* and *Type B units* shall be provided in Group R-4 occupancies in accordance with Sections 1107.6.4.1 and 1107.6.4.2.

1107.6.4.1 Accessible units. At least one of the *dwelling* or *sleeping units* shall be an *Accessible unit*.

1107.6.4.2 Type B units. In structures with four or more *dwelling units* or *sleeping units intended to be occupied as a residence*, every *dwelling unit* and *sleeping unit intended to be occupied as a residence* shall be a *Type B unit*.

Exception: The number of *Type B units* is permitted to be reduced in accordance with Section 1107.7.

1107.7 General exceptions. Where specifically permitted by Section 1107.5 or 1107.6, the required number of *Type A units* and *Type B units* is permitted to be reduced in accordance with Sections 1107.7.1 through 1107.7.5.

1107.7.1 Structures without elevator service. Where no elevator service is provided in a structure, only the *dwelling units* and *sleeping units* that are located on stories indicated in Sections 1107.7.1.1 and 1107.7.1.2 are required to be *Type A units* and *Type B units*, respectively. The number of *Type A units* shall be determined in accordance with Section 1107.6.2. 1. 1.

1107.7.1.1 One story with Type B units required. At least one *story* containing *dwelling units* or *sleeping units intended to be occupied as a residence* shall be provided with an *accessible* entrance from the exterior of the structure and all units *intended to be occupied as a residence* on that *story* shall be *Type B units*.

1107.7.1.2 Additional stories with Type B units. On all other stories that have a building entrance in proximity to arrival points intended to serve units on that *story*, as indicated in Items 1 and 2, all *dwelling units* and *sleeping units intended to be occupied as a residence* served by that entrance on that *story* shall be *Type B units*.

1. Where the slopes of the undisturbed *site* measured between the planned entrance and all vehicular or pedestrian arrival points within 50 feet (15 240 mm) of the planned entrance are 10 percent or less, and
2. Where the slopes of the planned finished grade measured between the entrance and all vehicular or pedestrian arrival points within 50 feet (15 240 mm) of the planned entrance are 10 percent or less.

Where no such arrival points are within 50 feet (15 240 mm) of the entrance, the closest arrival point shall be

used unless that arrival point serves the *story* required by Section 1107.7.1.1.

1107.7.2 Multistory units. A *multistory dwelling* or *sleeping unit* which is not provided with elevator service is not required to be a *Type B unit*. Where a *multistory unit* is provided with external elevator service to only one floor, the floor provided with elevator service shall be the primary entry to the unit, shall comply with the requirements for a *Type B unit* and a toilet facility shall be provided on that floor.

1107.7.3 Elevator service to the lowest story with units. Where elevator service in the building provides an *accessible route* only to the lowest *story* containing *dwelling* or *sleeping units intended to be occupied as a residence*, only the units on that *story* which are *intended to be occupied as a residence* are required to be *Type B units*.

1107.7.4 Site impracticality. On a *site* with multiple non-elevator buildings, the number of units required by Section 1107.7.1 to be *Type B units* is permitted to be reduced to a percentage which is equal to the percentage of the entire site having grades, prior to development, which are less than 10 percent, provided that all of the following conditions are met:

1. Not less than 20 percent of the units required by Section 1107.7.1 on the *site* are *Type B units*;
2. Units required by Section 1107.7.1, where the slope between the building entrance serving the units on that *story* and a pedestrian or vehicular arrival point is no greater than 8.33 percent, are *Type B units*;
3. Units required by Section 1107.7.1, where an elevated walkway is planned between a building entrance serving the units on that *story* and a pedestrian or vehicular arrival point and the slope between them is 10 percent or less are *Type B units*; and
4. Units served by an elevator in accordance with Section 1107.7.3 are *Type B units*.

1107.7.5 Design flood elevation. The required number of *Type A units* and *Type B units* shall not apply to a *site* where the required elevation of the lowest floor or the lowest horizontal structural building members of nonelevator buildings are at or above the *design flood elevation* resulting in:

1. A difference in elevation between the minimum required floor elevation at the primary entrances and vehicular and pedestrian arrival points within 50 feet (15 240 mm) exceeding 30 inches (762 mm), and
2. A slope exceeding 10 percent between the minimum required floor elevation at the primary entrances and vehicular and pedestrian arrival points within 50 feet (15 240 mm).

Where no such arrival points are within 50 feet (15 240 mm) of the primary entrances, the closest arrival points shall be used.

SECTION 1108 SPECIAL OCCUPANCIES

1108.1 General. In addition to the other requirements of this chapter, the requirements of Sections 1108.2 through 1108.4 shall apply to specific occupancies.

1108.2 Assembly area seating. Assembly areas with fixed seating shall comply with Sections 1108.2.1 through 1108.2.8. Dining areas shall comply with Section 1108.2.9. In addition, lawn seating which is provided accessory to an affected building, shall comply with Section 1108.2.6.

1108.2.1 Services. If a service or facility is provided in an area that is not *accessible*, the same service or facility shall be provided on an *accessible* level and shall be *accessible*.

1108.2.2 Wheelchair spaces. In theaters, *bleachers*, *grandstands*, stadiums, arenas and other fixed seating assembly areas, *accessible wheelchair spaces* complying with ICC A117.1 shall be provided in accordance with Sections 1108.2.2.1 through 1108.2.2.4.

1108.2.2.1 General seating. *Wheelchair spaces* shall be provided in accordance with Table 1108.2.2.1.

1108.2.2.2 Luxury boxes, club boxes and suites. In each luxury box, club box, and suite within arenas, stadiums and *grandstands*, *wheelchair spaces* shall be provided in accordance with Table 1108.2.2.1.

1108.2.2.3 Other boxes. In boxes other than those required to comply with Section 1108.2.2.2, the total number of *wheelchair spaces* provided shall be determined in accordance with Table 1108.2.2.1. *Wheelchair spaces* shall be located in not less than 20 percent of all boxes provided.

**TABLE 1108.2.2.1
ACCESSIBLE WHEELCHAIR SPACES**

CAPACITY OF SEATING IN ASSEMBLY AREAS	MINIMUM REQUIRED NUMBER OF WHEELCHAIR SPACES
4 to 25	1
26 to 50	2
51 to 100	4
101 to 300	5
301 to 500	6
501 to 5,000	6, plus 1 for each 150, or fraction thereof, between 501 through 5,000
5,001 and over	36 plus 1 for each 200, or fraction thereof, over 5,000

1108.2.2.4 Team or player seating. At least one *wheelchair space* shall be provided in team or player seating areas serving areas of sport activity.

Exception: *Wheelchair spaces* shall not be required in team or player seating areas serving bowling lanes that are not required to be located on an *accessible route* in accordance with Section 1109.14.4.1.

1108.2.3 Companion seats. At least one companion seat complying with ICC A117.1 shall be provided for each *wheelchair space* required by Sections 1108.2.2.1 through 1108.2.2.3.

1108.2.4 Dispersion of wheelchair spaces in multilevel assembly seating areas. In *multilevel assembly seating* areas, *wheelchair spaces* shall be provided on the main floor level and on one of each two additional floor or *mezzanine* levels. *Wheelchair spaces* shall be provided in each luxury box, club box and suite within assembly facilities.

1. In multilevel assembly spaces utilized for worship services where the second floor or *mezzanine* level contains 25 percent or less of the total seating capacity, *wheelchair spaces* shall be permitted to all be located on the main level.
2. In *multilevel assembly seating* where the second floor or *mezzanine* level provides 25 percent or less of the total seating capacity and 300 or fewer seats, all *wheelchair spaces* shall be permitted to be located on the main level.
3. *Wheelchair spaces* in team or player seating serving areas of sport activity are not required to be dispersed.

1108.2.5 Designated aisle seats. At least 5 percent, but not less than one, of the total number of aisle seats provided shall be designated aisle seats and shall be the aisle seats located closest to *accessible routes*.

Exception: Designated aisle seats are not required in team or player seating serving areas of sport activity.

1108.2.6 Lawn seating. Lawn seating areas and exterior overflow seating areas, where fixed seats are not provided, shall connect to an *accessible route*.

1108.2.7 Assistive listening systems. Each assembly area where audible communications are integral to the use of the space shall have an assistive listening system.

Exception: Other than in courtrooms, an assistive listening system is not required where there is no audio amplification system.

1108.2.7.1 Receivers. Receivers shall be provided for assistive listening systems in accordance with Table 1108.2.7.1.

Exceptions:

1. Where a building contains more than one assembly area, the total number of required receivers shall be permitted to be calculated according to the total number of seats in the assembly areas in the building, provided that all receivers are usable with all systems and if assembly areas required to provide assistive listening are under one management.
2. Where all seats in an assembly area are served by an induction loop assistive listening system, the minimum number of receivers required by Table 1108.2.7.1 to be hearing-aid compatible shall not be required.

1108.2.7.2 Public address systems. Where stadiums, arenas and *grandstands* provide audible public announcements, they shall also provide equivalent text information regarding events and facilities in compliance with Sections 1108.2.7.2.1 and 1108.2.7.2.2.

**TABLE 1108.2.7.1
RECEIVERS FOR ASSISTIVE LISTENING SYSTEMS**

CAPACITY OF SEATING IN ASSEMBLY AREAS	MINIMUM REQUIRED NUMBER OF RECEIVERS	MINIMUM NUMBER OF RECEIVERS TO BE HEARING-AID COMPATIBLE
50 or less	2	2
51 to 200	2, plus 1 per 25 seats over 50 seats*	2
201 to 500	2, plus 1 per 25 seats over 50 seats*	1 per 4 receivers*
501 to 1,000	20, plus 1 per 33 seats over 500 seats*	1 per 4 receivers*
1,001 to 2,000	35, plus 1 per 50 seats over 1,000 seats*	1 per 4 receivers*
Over 2,000	55, plus 1 per 100 seats over 2,000 seats*	1 per 4 receivers*

Note: * = or fraction thereof

1108.2.7.2.1 Prerecorded text messages. Where electronic signs are provided and have the capability to display prerecorded text messages containing information that is the same, or substantially equivalent to information that is provided audibly, signs shall display text that is equivalent to audible announcements.

Exception: Announcements that cannot be prerecorded in advance of the event shall not be required to be displayed.

1108.2.7.2.2 Real-time messages. Where electronic signs are provided and have the capability to display real-time messages containing information that is the same, or substantially equivalent, to information that is provided audibly, signs shall display text that is equivalent to audible announcements.

1108.2.8 Performance areas. An *accessible route* shall directly connect the performance area to the assembly seating area where a *circulation path* directly connects a performance area to an assembly seating area. An *accessible route* shall be provided from performance areas to ancillary areas or facilities used by performers.

1108.2.9 Dining areas. In dining areas, the total floor area allotted for seating and tables shall be *accessible*.

Exceptions:

1. In buildings or facilities not required to provide an *accessible route* between levels, an *accessible route* to a *mezzanine* seating area is not required, provided that the *mezzanine* contains less than 25 percent of the total area and the same services are provided in the *accessible* area.
2. In sports facilities, tiered dining areas providing seating required to be *accessible* shall be required to have *accessible routes* serving at least 25 percent of the dining area, provided that *accessible routes* serve *accessible* seating and where each tier is provided with the same services.

1108.2.9.1 Dining surfaces. Where dining surfaces for the consumption of food or drink are provided, at least 5 percent, but not less than one, of the dining surfaces for the seating and standing spaces shall be *accessible* and

be distributed throughout the facility and located on a level accessed by an *accessible route*. Where a bar or counter is provided for consumption of food or drink exceeding 34 inches (864 mm) in height, a structurally integrated portion of the main bar or counter shall be provided, a minimum 60 inches (1524 mm) long or 5 percent of the length, whichever is greater, and 28 inches to 34 inches (711 mm to 864 mm) high. Clear floor space for forward approach and knee and toe clearance shall be provided.

Flip-up counters, adjacent tables and similar devices shall not be permitted to satisfy this requirement.

1108.3 Self-service storage facilities. *Self-service storage facilities* shall provide accessible individual self-storage spaces in accordance with Table 1108.3.

**TABLE 1108.3
ACCESSIBLE SELF-SERVICE STORAGE FACILITIES**

TOTAL SPACES IN FACILITY	MINIMUM NUMBER OF REQUIRED ACCESSIBLE SPACES
1 to 200	5%, but not less than 1
Over 200	10, plus 2% of total number of units over 200

1108.3.1 Dispersion. *Accessible* individual self-service storage spaces shall be dispersed throughout the various classes of spaces provided. Where more classes of spaces are provided than the number of required *accessible* spaces, the number of *accessible* spaces shall not be required to exceed that required by Table 1108.3. *Accessible* spaces are permitted to be dispersed in a single building of a multi-building facility.

1108.4 Judicial facilities. Judicial facilities shall comply with Sections 1108.4.1 through 1108.4.3.

1108.4.1 Courtrooms. Each courtroom shall be *accessible* and comply with Sections 1108.4.1.1 through 1108.4.1.5.

1108.4.1.1 Jury box. A *wheelchair space* complying with ICC A117.1 shall be provided within the jury box.

Exception: Adjacent companion seating is not required.

1108.4.1.2 Gallery seating. *Wheelchair spaces* complying with ICC A117.1 shall be provided in accordance

with Table 1108.2.2.1. Designated aisle seats shall be provided in accordance with Section 1108.2.5.

1108.4.1.3 Assistive listening systems. An assistive listening system must be provided. Receivers shall be provided for the assistive listening system in accordance with Section 1108.2.7.1.

1108.4.1.4 Employee work stations. The judge's bench, clerk's station, bailiff's station, deputy clerk's station and court reporter's station shall be located on an *accessible route*. The vertical access to elevated employee work stations within a courtroom is not required at the time of initial construction, provided a *ramp*, lift or elevator complying with ICC A117.1 can be installed without requiring reconfiguration or extension of the courtroom or extension of the electrical system.

1108.4.1.5 Other work stations. The litigant's and counsel stations, including the lectern, shall be *accessible* in accordance with ICC A117.1.

1108.4.2 Holding cells. Central holding cells and court-floor holding cells shall comply with Sections 1108.4.2.1 and 1108.4.2.2.

1108.4.2.1 Central holding cells. Where separate central holding cells are provided for adult males, juvenile males, adult females or juvenile females, one of each type shall be *accessible*. Where central holding cells are provided and are not separated by age or sex, at least one *accessible* cell shall be provided.

1108.4.2.2 Court-floor holding cells. Where separate court-floor holding cells are provided for adult males, juvenile males, adult females or juvenile females, each courtroom shall be served by one *accessible* cell of each type. Where court-floor holding cells are provided and are not separated by age or sex, courtrooms shall be served by at least one *accessible* cell. *Accessible* cells shall be permitted to serve more than one courtroom.

1108.4.3 Visiting areas. Visiting areas shall comply with Sections 1108.4.3.1 and 1108.4.3.2.

1108.4.3.1 Cubicles and counters. At least 5 percent but no fewer than one of the cubicles shall be *accessible* on both the visitor and detainee sides. Where counters are provided, at least one shall be *accessible* on both the visitor and detainee sides.

Exception: This requirement shall not apply to the detainee side of cubicles or counters at noncontact visiting areas not serving *accessible* holding cells.

1108.4.3.2 Partitions. Where solid partitions or security glazing separate visitors from detainees, at least one of each type of cubicle or counter partition shall be *accessible*.

SECTION 1109 OTHER FEATURES AND FACILITIES

1109.1 General. *Accessible* building features and facilities shall be provided in accordance with Sections 1109.2 through 1109.14.

Exception: *Type A units* and *Type B units* shall comply with ICC A117.1.

1109.2 Toilet and bathing facilities. Each toilet room and bathing room shall be *accessible*. Where a floor level is not required to be connected by an *accessible route*, the only toilet rooms or bathing rooms provided within the facility shall not be located on the inaccessible floor. At least one of each type of fixture, element, control or dispenser in each *accessible* toilet room and bathing room shall be *accessible*.

Exceptions:

1. In toilet rooms or bathing rooms accessed only through a private office, not for *common* or *public use* and intended for use by a single occupant, any of the following alternatives are allowed:
 - 1.1. Doors are permitted to swing into the clear floor space, provided the door swing can be reversed to meet the requirements in ICC A117.1;
 - 1.2. The height requirements for the water closet in ICC A117.1 are not applicable;
 - 1.3. Grab bars are not required to be installed in a toilet room, provided that reinforcement has been installed in the walls and located so as to permit the installation of such grab bars; and
 - 1.4. The requirement for height, knee and toe clearance shall not apply to a lavatory.
2. This section is not applicable to toilet and bathing rooms that serve *dwelling units* or *sleeping units* that are not required to be *accessible* by Section 1107.
3. Where multiple single-user toilet rooms or bathing rooms are clustered at a single location, at least 50 percent but not less than one room for each use at each cluster shall be *accessible*.
4. Where not more than one urinal is provided in a toilet room or bathing room, the urinal is not required to be *accessible*.
5. Toilet rooms that are part of critical care or intensive care patient sleeping rooms are not required to be *accessible*.

1109.2.1 Family or assisted-use toilet and bathing rooms. In assembly and mercantile occupancies, an *accessible* family or assisted-use toilet room shall be provided where an aggregate of six or more male and female water closets is required. In buildings of mixed occupancy, only those water closets required for the assembly or mercantile occupancy shall be used to determine the family or assisted-use toilet room requirement. In recreational facilities where separate-sex bathing rooms are provided, an *accessible* family or assisted-use bathing room shall be provided. Fixtures located within family or assisted-use toilet and bathing rooms shall be included in determining the number of fixtures provided in an occupancy.

Exception: Where each separate-sex bathing room has only one shower or bathtub fixture, a family or assisted-use bathing room is not required.

1109.2.1.1 Standard. Family or assisted-use toilet and bathing rooms shall comply with Sections 1109.2.1.2 through 1109.2.1.7 and ICC A117.1.

1109.2.1.2 Family or assisted-use toilet rooms. Family or assisted-use toilet rooms shall include only one water closet and only one lavatory. A family or assisted-use bathing room in accordance with Section 1109.2.1.3 shall be considered a family or assisted-use toilet room.

Exception: A urinal is permitted to be provided in addition to the water closet in a family or assisted-use toilet room.

1109.2.1.3 Family or assisted-use bathing rooms. Family or assisted-use bathing rooms shall include only one shower or bathtub fixture. Family or assisted-use bathing rooms shall also include one water closet and one lavatory. Where storage facilities are provided for separate-sex bathing rooms, *accessible* storage facilities shall be provided for family or assisted-use bathing rooms.

1109.2.1.4 Location. Family or assisted-use toilet and bathing rooms shall be located on an *accessible route*. Family or assisted-use toilet rooms shall be located not more than one *story* above or below separate-sex toilet rooms. The *accessible route* from any separate-sex toilet room to a family or assisted-use toilet room shall not exceed 500 feet (152 m).

1109.2.1.5 Prohibited location. In passenger transportation facilities and airports, the *accessible route* from separate-sex toilet rooms to a family or assisted-use toilet room shall not pass through security checkpoints.

1109.2.1.6 Clear floor space. Where doors swing into a family or assisted-use toilet or bathing room, a clear floor space not less than 30 inches by 48 inches (762 mm by 1219 mm) shall be provided, within the room, beyond the area of the door swing.

1109.2.1.7 Privacy. Doors to family or assisted-use toilet and bathing rooms shall be securable from within the room.

1109.2.2 Water closet compartment. Where water closet compartments are provided in a toilet room or bathing room, at least one wheelchair-*accessible* compartment shall be provided. Where the combined total water closet compartments and urinals provided in a toilet room or bathing room is six or more, at least one ambulatory-*accessible* water closet compartment shall be provided in addition to the wheelchair-*accessible* compartment. Wheelchair-*accessible* and ambulatory-*accessible* compartments shall comply with ICC A117.1.

1109.2.3 Lavatories. Where lavatories are provided, at least 5 percent, but not less than one, shall be *accessible*. Where the total lavatories provided in a toilet room or bathing facility is six or more, at least one lavatory with enhanced reach ranges in accordance with ICC A117.1, shall be provided.

1109.3 Sinks. Where sinks are provided, at least 5 percent but not less than one provided in *accessible* spaces shall comply with ICC A117.1.

Exception: Mop or service sinks are not required to be *accessible*.

1109.4 Kitchens and kitchenettes. Where kitchens and kitchenettes are provided in *accessible* spaces or rooms, they shall be *accessible* in accordance with ICC A117.1.

1109.5 Drinking fountains. Where drinking fountains are provided on an exterior site, on a floor or within a secured area, the drinking fountains shall be provided in accordance with Sections 1109.5.1 and 1109.5.2.

1109.5.1 Minimum number. No fewer than two drinking fountains shall be provided. One drinking fountain shall comply with the requirements for people who use a wheelchair and one drinking fountain shall comply with the requirements for standing persons.

Exception: A single drinking fountain that complies with the requirements for people who use a wheelchair and standing persons shall be permitted to be substituted for two separate drinking fountains.

1109.5.2 More than the minimum number. Where more than the minimum number of drinking fountains specified in Section 1109.5.1 are provided, 50 percent of the total number of drinking fountains provided shall comply with the requirements for persons who use a wheelchair and 50 percent of the total number of drinking fountains provided shall comply with the requirements for standing persons.

Exception: Where 50 percent of the drinking fountains yields a fraction, 50 percent shall be permitted to be rounded up or down, provided that the total number of drinking fountains complying with this section equals 100 percent of the drinking fountains.

1109.6 Elevators. Passenger elevators on an *accessible route* shall be *accessible* and comply with Section 3001.3.

1109.7 Lifts. Platform (wheelchair) lifts are permitted to be a part of a required *accessible route* in new construction where indicated in Items 1 through 10. Platform (wheelchair) lifts shall be installed in accordance with the *Oregon Elevator Specialty Code*.

1. An *accessible route* to a performing area and speaker platforms in Group A occupancies.
2. An *accessible route* to *wheelchair spaces* required to comply with the *wheelchair space* dispersion requirements of Sections 1108.2.2 through 1108.2.6.
3. An *accessible route* to spaces that are not open to the general public with an *occupant load* of not more than five.
4. An *accessible route* within a *dwelling* or *sleeping unit*.
5. An *accessible route* to wheelchair seating spaces located in outdoor dining terraces in Group A-5 occupancies where the *means of egress* from the dining terraces to a *public way* are open to the outdoors.

6. An *accessible route* to jury boxes and witness stands; raised courtroom stations including judges' benches, clerks' stations, bailiffs' stations, deputy clerks' stations and court reporters' stations; and to depressed areas such as the well of the court.
7. An *accessible route* to load and unload areas serving amusement rides.
8. An *accessible route* to play components or soft contained play structures.
9. An *accessible route* to team or player seating areas serving areas of sport activity.
10. An *accessible route* where existing exterior *site* constraints make use of a ramp or elevator infeasible.

1109.8 Storage. Where fixed or built-in storage elements such as cabinets, shelves, medicine cabinets, closets and drawers are provided in required *accessible* spaces, at least one of each type shall contain storage space complying with ICC A117.1.

1109.8.1 Lockers. Where lockers are provided in *accessible* spaces, at least five percent, but not less than one, of each type shall be *accessible*.

1109.8.2 Shelving and display units. Self-service shelves and display units shall be located on an *accessible route*. Such shelving and display units shall not be required to comply with reach-range provisions.

1109.8.3 Coat hooks and shelves. Where coat hooks and shelves are provided in toilet rooms or toilet compartments or in dressing, fitting or locker rooms, at least one of each type shall be *accessible* and shall be provided in *accessible* toilet rooms without toilet compartments, *accessible* toilet compartments and *accessible* dressing, fitting and locker rooms.

1109.9 Detectable warnings. Passenger transit platform edges bordering a drop-off and not protected by platform screens or *guards* shall have a *detectable warning*.

Exception: *Detectable warnings* are not required at bus stops.

1109.10 Seating at tables, counters and work surfaces. Where seating or standing space at fixed or built-in tables, counters or work surfaces is provided in *accessible* spaces, at least 5 percent of the seating and standing spaces, but not less than one, shall be *accessible*. In Group I-3 occupancy visiting areas at least 5 percent, but not less than one, cubicle or counter shall be *accessible* on both the visitor and detainee sides.

Exceptions:

1. Check-writing surfaces at check-out aisles not required to comply with Section 1109.11.2 are not required to be *accessible*.
2. In Group I-3 occupancies, the counter or cubicle on the detainee side is not required to be *accessible* at noncontact visiting areas or in areas not serving *accessible* holding cells or *sleeping units*.

1109.10.1 Dispersion. *Accessible* fixed or built-in seating at tables, counters or work surfaces shall be distributed

throughout the space or facility containing such elements and located on a level accessed by an *accessible route*.

1109.11 Service facilities. Service facilities shall provide for *accessible* features in accordance with Sections 1109.11.1 through 1109.11.5.

1109.11.1 Dressing, fitting and locker rooms. Where dressing rooms, fitting rooms or locker rooms are provided, at least 5 percent, but not less than one, of each type of use in each cluster provided shall be *accessible*.

1109.11.2 Check-out aisles. Where check-out aisles are provided, *accessible* check-out aisles shall be provided in accordance with Table 1109.11.2. Where check-out aisles serve different functions, at least one *accessible* check-out aisle shall be provided for each function. Where check-out aisles serve different functions, *accessible* check-out aisles shall be provided in accordance with Table 1109.11.2 for each function. Where check-out aisles are dispersed throughout the building or facility, *accessible* check-out aisles shall also be dispersed. Traffic control devices, security devices and turnstiles located in *accessible* check-out aisles or lanes shall be *accessible*.

TABLE 1109.11.2
ACCESSIBLE CHECK-OUT AISLES

TOTAL CHECK-OUT AISLES OF EACH FUNCTION	MINIMUM NUMBER OF ACCESSIBLE CHECK-OUT AISLES OF EACH
1 to 4	
5 to 8	
9 to 15	
Over 15	3, plus 20% of additional aisles

1109.11.3 Point of sale and service counters. Where counters are provided for sales or distribution of goods or services, at least one of each type provided shall be *accessible*. Where such counters are dispersed throughout the building or facility, *accessible* counters shall also be dispersed.

1109.11.4 Food service lines. Food service lines shall be *accessible*. Where self-service shelves are provided, at least 50 percent, but not less than one, of each type provided shall be *accessible*.

1109.11.5 Queue and waiting lines. Queue and waiting lines servicing *accessible* counters or check-out aisles shall be *accessible*.

1109.12 Controls, operating mechanisms and hardware. Controls, operating mechanisms and hardware intended for operation by the occupant, including switches that control lighting and ventilation and electrical convenience outlets, in *accessible* spaces, along *accessible routes* or as parts of *accessible* elements shall be *accessible*.

Exceptions:

1. Operable parts that are intended for use only by service or maintenance personnel shall not be required to be *accessible*.
2. Electrical or communication receptacles serving a dedicated use shall not be required to be *accessible*.

3. Where two or more outlets are provided in a kitchen above a length of counter top that is uninterrupted by a sink or appliance, one outlet shall not be required to be *accessible*.
4. Floor electrical receptacles shall not be required to be *accessible*.
5. HVAC diffusers shall not be required to be *accessible*.
6. Except for light switches, where redundant controls are provided for a single element, one control in each space shall not be required to be *accessible*.
7. Access doors or gates in barrier walls and fences protecting pools, spas and hot tubs shall be permitted to have operable parts of the release of latch on self-latching devices at 54 inches (1370 mm) maximum and 48 inches (1219 mm) minimum above the finished floor or ground, provided the self-latching devices are not also self-locking devices, operated by means of a key, electronic opener, or integral combination lock.

1109.12.1 Operable window. Where operable windows are provided in rooms that are required to be *accessible* in accordance with Sections 1107.5.1.1, 1107.5.2.1, 1107.5.3.1, 1107.5.4, 1107.6.1.1, 1107.6.2.1.1, 1107.6.2.2.1 and 1107.6.4.1, at least one window in each room shall be *accessible* and each required operable window shall be *accessible*.

Exception: *Accessible* windows are not required in bathrooms and kitchens.

1109.13 Reserved.

1109.14 Recreational and sports facilities. Recreational and sports facilities shall be provided with *accessible* features in accordance with Sections 1109.14.1 through 1109.14.4.

1109.14.1 Facilities serving a single building. In Group R-2 and R-3 occupancies where recreational facilities are provided serving a single building containing *Type A units* or *Type B units*, 25 percent, but not less than one, of each type of recreational facility shall be *accessible*. Every recreational facility of each type on a site shall be considered to determine the total number of each type that is required to be *accessible*.

1109.14.2 Facilities serving multiple buildings. In Group R-2 and R-3 occupancies on a single *site* where multiple buildings containing *Type A units* or *Type B units* are served by recreational facilities, 25 percent, but not less than one, of each type of recreational facility serving each building shall be *accessible*. The total number of each type of recreational facility that is required to be *accessible* shall be determined by considering every recreational facility of each type serving each building on the site.

1109.14.3 Other occupancies. All recreational and sports facilities not falling within the purview of Section 1109.14.1 or 1109.14.2 shall be *accessible*.

1109.14.4 Recreational and sports facilities exceptions. Recreational and sports facilities required to be *accessible* shall be exempt from this chapter to the extent specified in this section.

1109.14.4.1 Bowling lanes. An *accessible route* shall be provided to at least 5 percent, but no less than one, of each type of bowling lane.

1109.14.4.2 Court sports. In court sports, at least one *accessible route* shall directly connect both sides of the court.

1109.14.4.3 Raised boxing or wrestling rings. Raised boxing or wrestling rings are not required to be *accessible*.

1109.14.4.4 Raised refereeing, judging and scoring areas. Raised structures used solely for refereeing, judging or scoring a sport are not required to be *accessible*.

SECTION 1110 SIGNAGE

1110.1 Signs. Required *accessible* elements shall be identified by the International Symbol of Accessibility at the following locations:

1. *Accessible* parking spaces required by Section 1106.1 except where the total number of parking spaces provided is four or less.
2. *Accessible* passenger loading zones.
3. *Accessible* rooms where multiple single-user toilet or bathing rooms are clustered at a single location.
4. *Accessible* entrances where not all entrances are *accessible*.
5. *Accessible* check-out aisles where not all aisles are *accessible*. The sign, where provided, shall be above the check-out aisle in the same location as the check-out aisle number or type of check-out identification.
6. Unisex toilet and bathing rooms.
7. *Accessible* dressing, fitting and locker rooms where not all such rooms are *accessible*.
8. *Accessible areas of refuge* in accordance with Section 1007.9.
9. Exterior areas for assisted rescue in accordance with Section 1007.9.

1110.2 Directional signage. Directional signage indicating the route to the nearest like *accessible* element shall be provided at the following locations. These directional signs shall include the International Symbol of Accessibility:

1. Inaccessible building entrances.
2. Inaccessible public toilets and bathing facilities.
3. Elevators not serving an *accessible route*.
4. At each separate-sex toilet and bathing room indicating the location of the nearest family or assisted-use toilet or bathing room where provided in accordance with Section 1109.2.1.
5. At *exits* and *exit stairways* serving a required *accessible* space, but not providing an *approved accessible means of egress*, signage shall be provided in accordance with Section 1007.10.

1110.3 Other signs. Signage indicating special accessibility provisions shall be provided as shown:

1. Each assembly area required to comply with Section 1108.2.7 shall provide a sign notifying patrons of the availability of assistive listening systems.

Exception: Where ticket offices or windows are provided, signs are not required at each assembly area provided that signs are displayed at each ticket office or window informing patrons of the availability of assistive listening systems.
2. At each door to an *area of refuge*, an exterior area for assisted rescue, an egress *stairway*, *exit passageway* and *exit discharge*, signage shall be provided in accordance with Section 1011.3.
3. At *areas of refuge*, signage shall be provided in accordance with Section 1007.11.
4. At exterior areas for assisted rescue, signage shall be provided in accordance with Section 1007.11.
5. At two-way communication systems, signage shall be provided in accordance with Section 1007.8.2.
6. Within *exit enclosures*, signage shall be provided in accordance with Section 1022.8.

SECTION 1111 CLUSTERED MAILBOXES

1111.1 Accessible routes. Clustered mailboxes on a site with an affected building shall be located on an accessible route in compliance with Sections 402 and 403 of ICC A117.1.

1111.2 Within a site. At least one accessible route shall connect accessible buildings, accessible facilities, accessible elements and accessible spaces that are on the same site.

1111.3 Site arrival points. Accessible routes within the site shall be provided from public transportation stops; accessible parking; accessible passenger loading zones; and public streets or sidewalks to the accessible facilities served.

1111.3.1 Location. Location of clustered mailboxes shall be coordinated with the postal authority having jurisdiction.

1111.3.2 Access to pedestrian circulation. Where an improved walking surface such as a sidewalk is located within 50 feet (15 240 mm) of the pad on which a clustered mailbox unit is located, at least one accessible route shall connect the improved walking surface to the clustered mailbox pad. At least one pedestrian access route shall be provided within 50 feet (15 240 mm) from the vehicular way to the pad on which a clustered mailbox unit is located.

1111.4 Ramps, curb ramps and barriers. Ramps along an accessible route to clustered mailboxes shall be in compliance with Sections 405 and 406 of ICC A117.1.

1111.4.1 Curb ramps. Where the accessible route to clustered mailboxes is obstructed by curbs, curb ramps shall be provided within 50 feet (15 240 mm) of the clustered mailbox location.

1111.4.2 Other barriers. Where barriers such as grass median, landscaping or loose gravel between the edge of the traveled surface and clustered mailbox pads occur a solid surfaced access shall be provided within 50 feet (15 240 mm) of the clustered mailbox location.

1111.4.3 Landings. All landings along an accessible route to clustered mailboxes shall conform to Section 405.7 of ICC A117.1.

1111.4.4 Edge protection. Edge protection along an accessible route to clustered mailboxes shall comply with Section 405.9 of ICC A117.1.

1111.5 Changes in level. Changes in level in the traveled surface on an accessible route to clustered mailboxes shall comply with Section 303 of ICC A117.1.

1111.6 Surfaces. Traveled surfaces shall be stable, firm, and slip resistant, and shall comply with ICC A117.1 Sections 302.1 and 302.3. Changes in level in floor surfaces shall comply with Section 303 of ICC A117.1.

1111.7 Turning space at clustered mailbox units. At least one turning space shall be provided at the front of each clustered mailbox unit. The turning space shall conform to ICC A117.1 Section 304 and shall be either:

1. A circular space having a 72-inch-minimum (1829 mm) diameter; or
2. A T-shaped space within a 72-inch-minimum (1829 mm) square, with arms and base 48 inches minimum (1219 mm) in width. Each arm of the T shall be clear of obstructions 24 inches (610 mm) minimum in each direction, and the base shall be clear of obstructions 36 inches (914 mm) minimum. The turning space shall be permitted to include knee and toe clearance complying with Section 306 only at the end of either the base or one arm.

1111.8 Protruding objects. Protruding objects along the accessible route to clustered mailboxes shall conform to Section 307 of ICC A117.1

1111.9 Clear access space. Clear access space conforming to Section 305 of ICC A117.1 shall be provided to each of the mailboxes at the clustered mailbox location. The clear access space and the turning space may overlap.

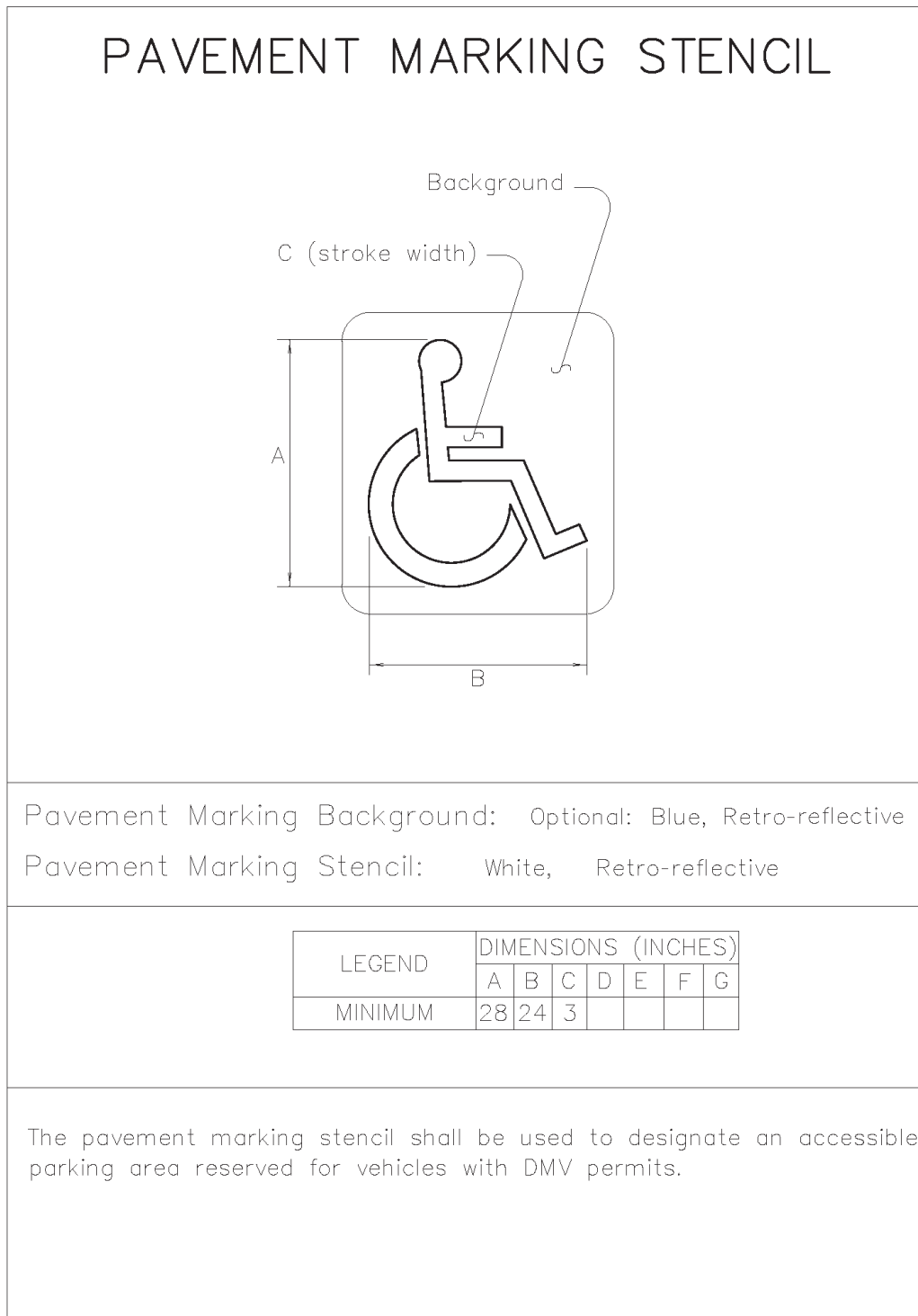

For SI: 1 inch = 25.4 mm.

FIGURE 1

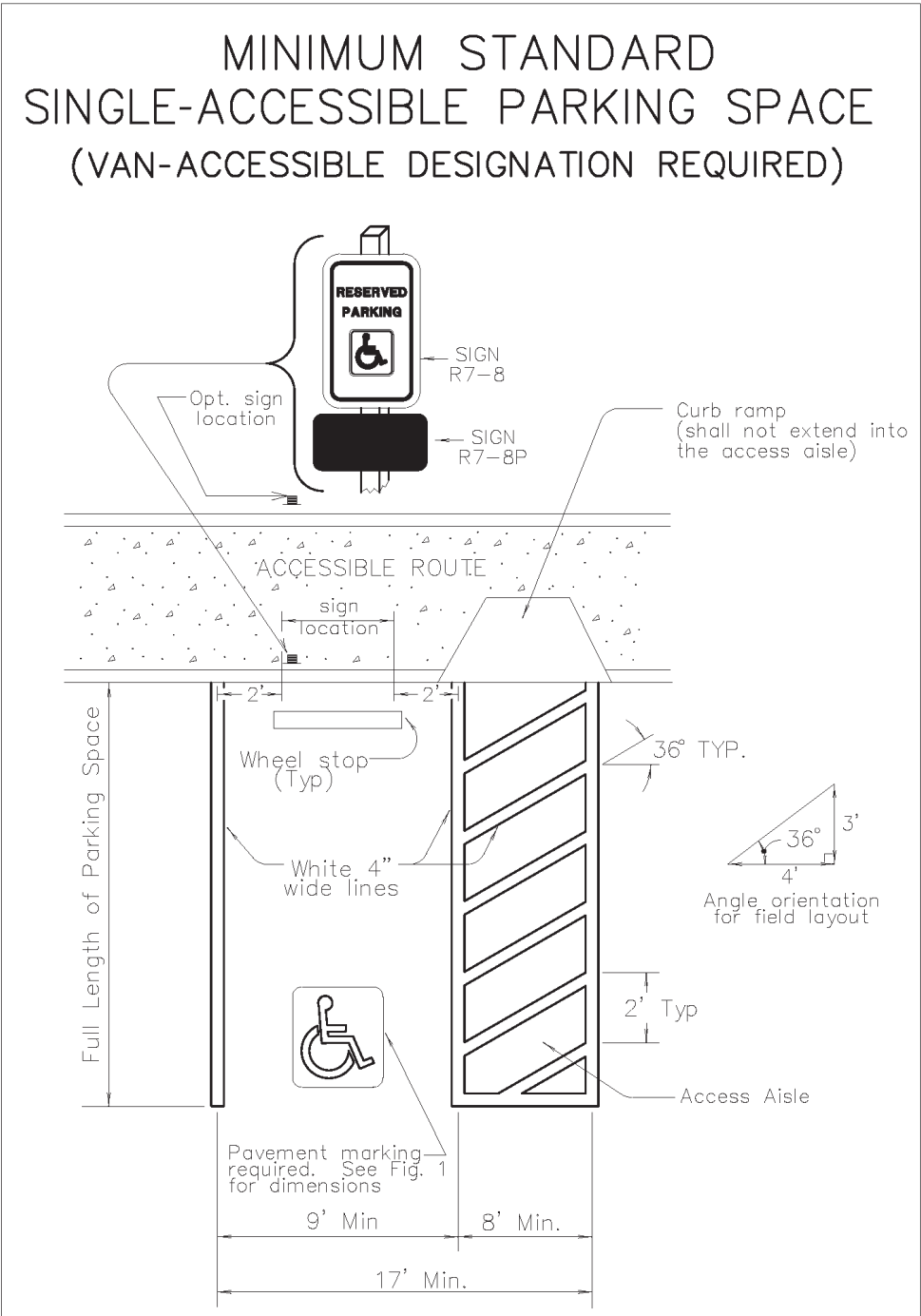

For SI: 1 foot = 304.8 mm, 1 degree = 0.01745 rad.

FIGURE 2

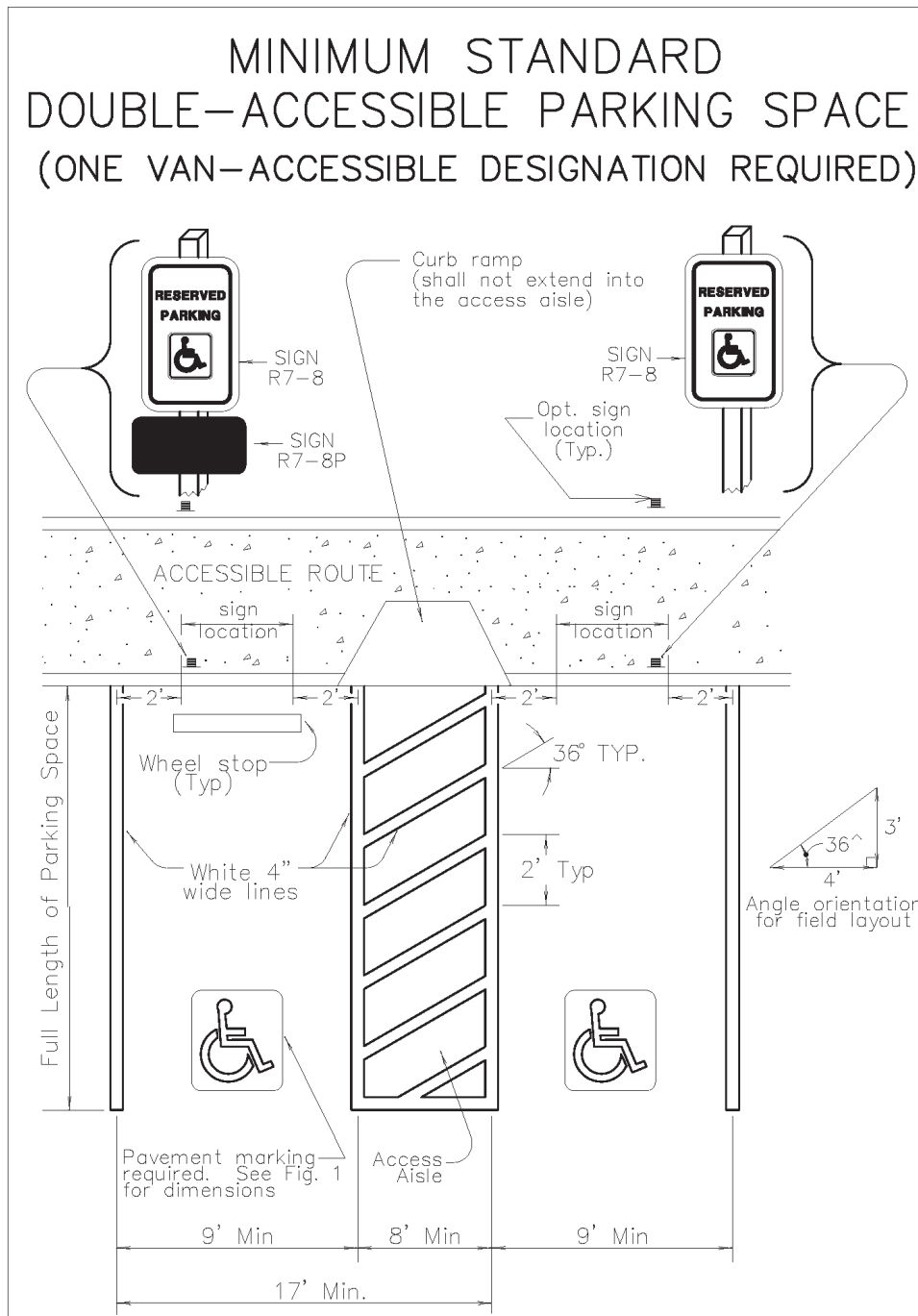
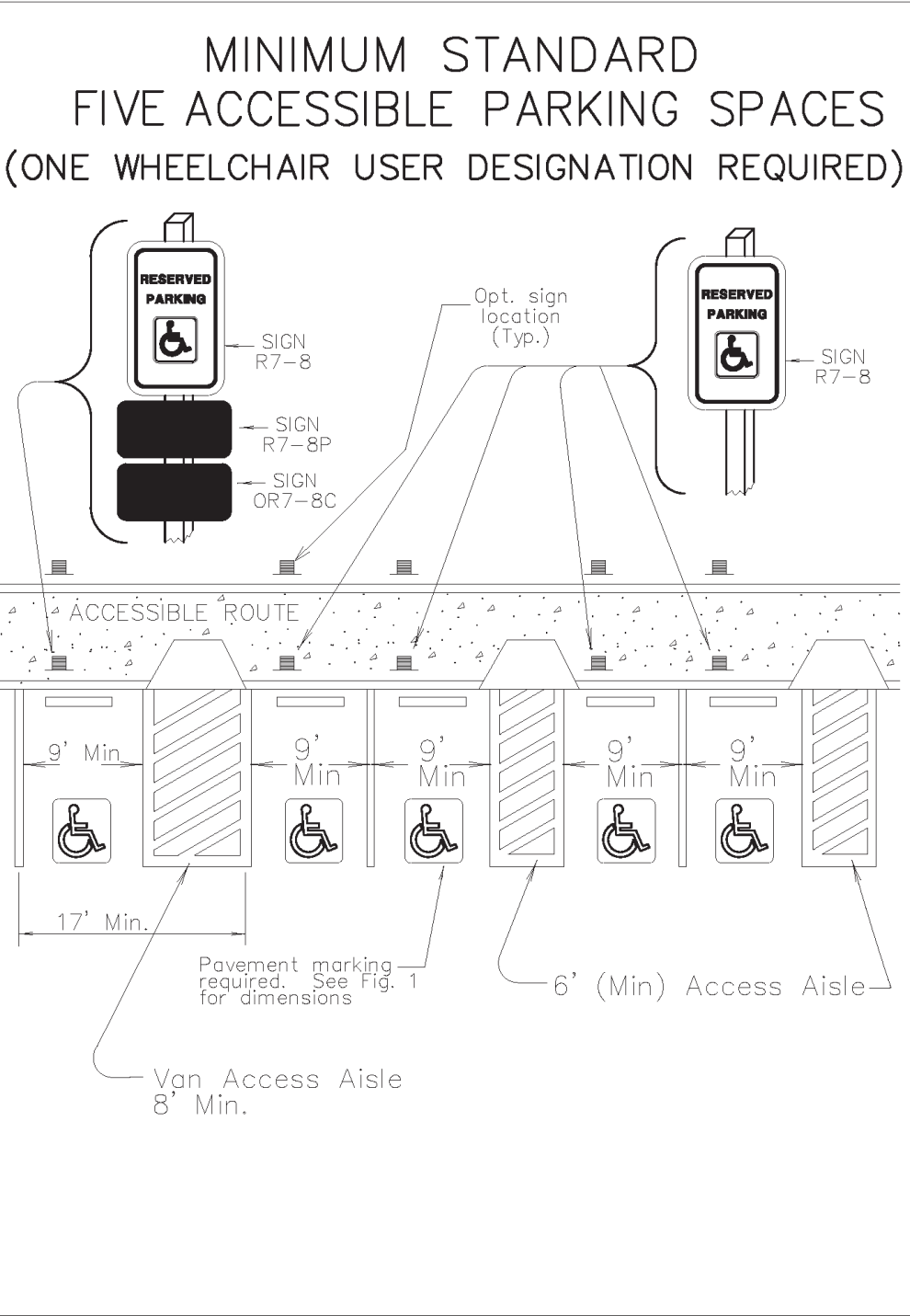

Figure 3

For SI: 1 foot = 304.8 mm, 1 degree = 0.01745 rad.

FIGURE 3



For SI: 1 foot = 304.8 mm.

FIGURE 4

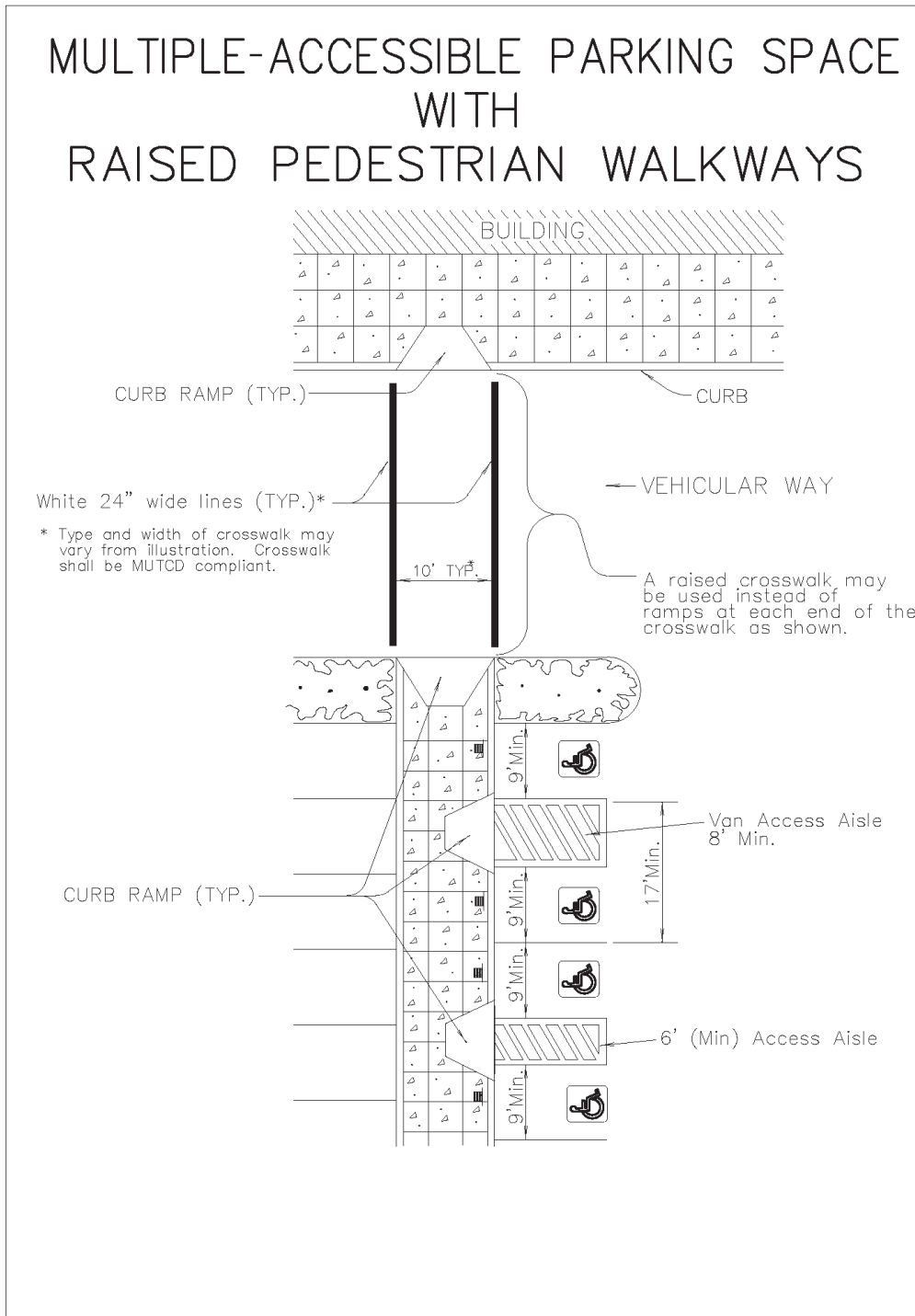

For SI: 1 inch = 25.4 mm, 1 foot = 304.8 mm.

FIGURE 5

MULTIPLE-ACCESSIBLE PARKING SPACE WITH AT-GRADE PEDESTRIAN WALKWAYS

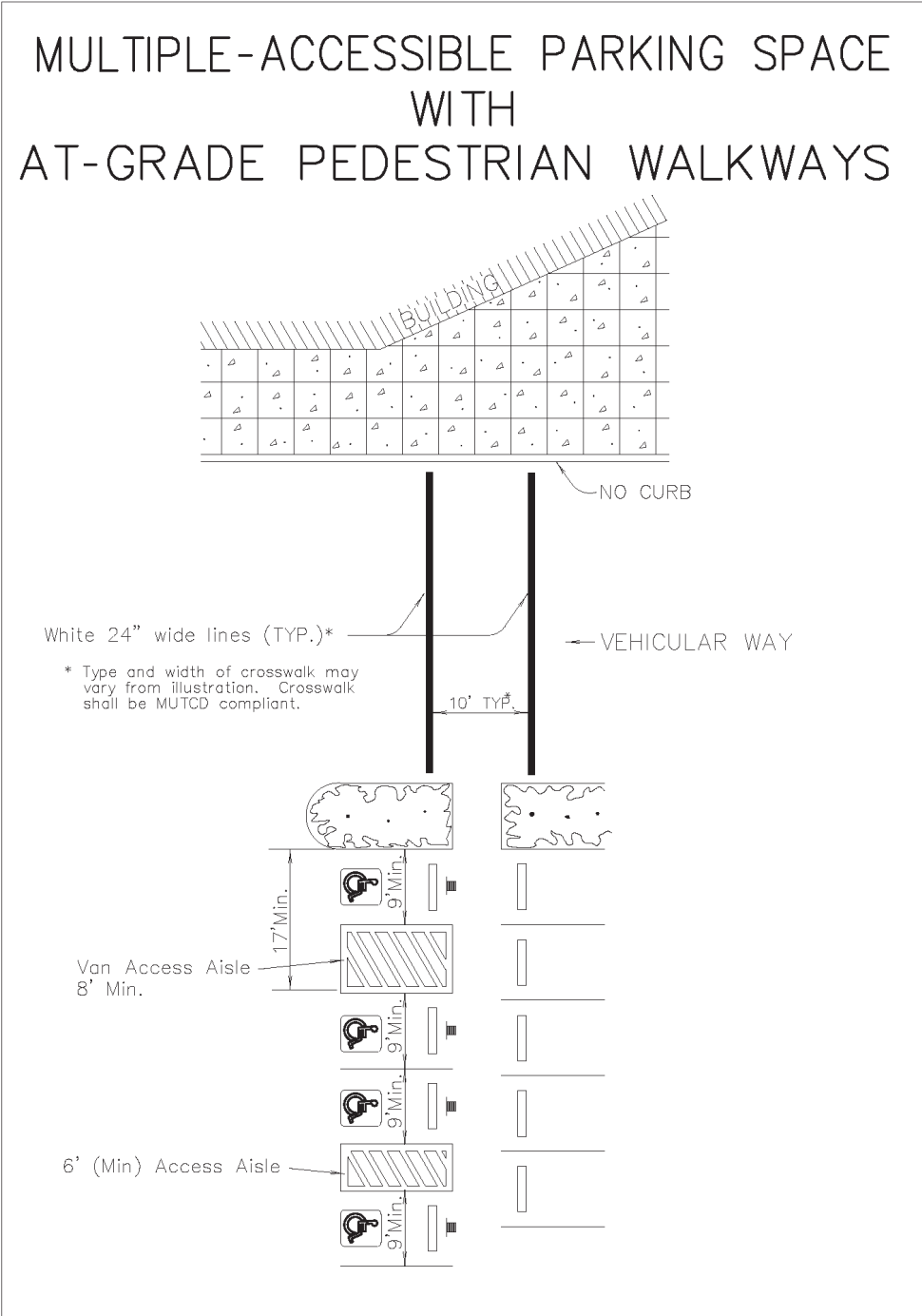

For SI: 1 inch = 25.4 mm, 1 foot = 304.8 mm.

FIGURE 6

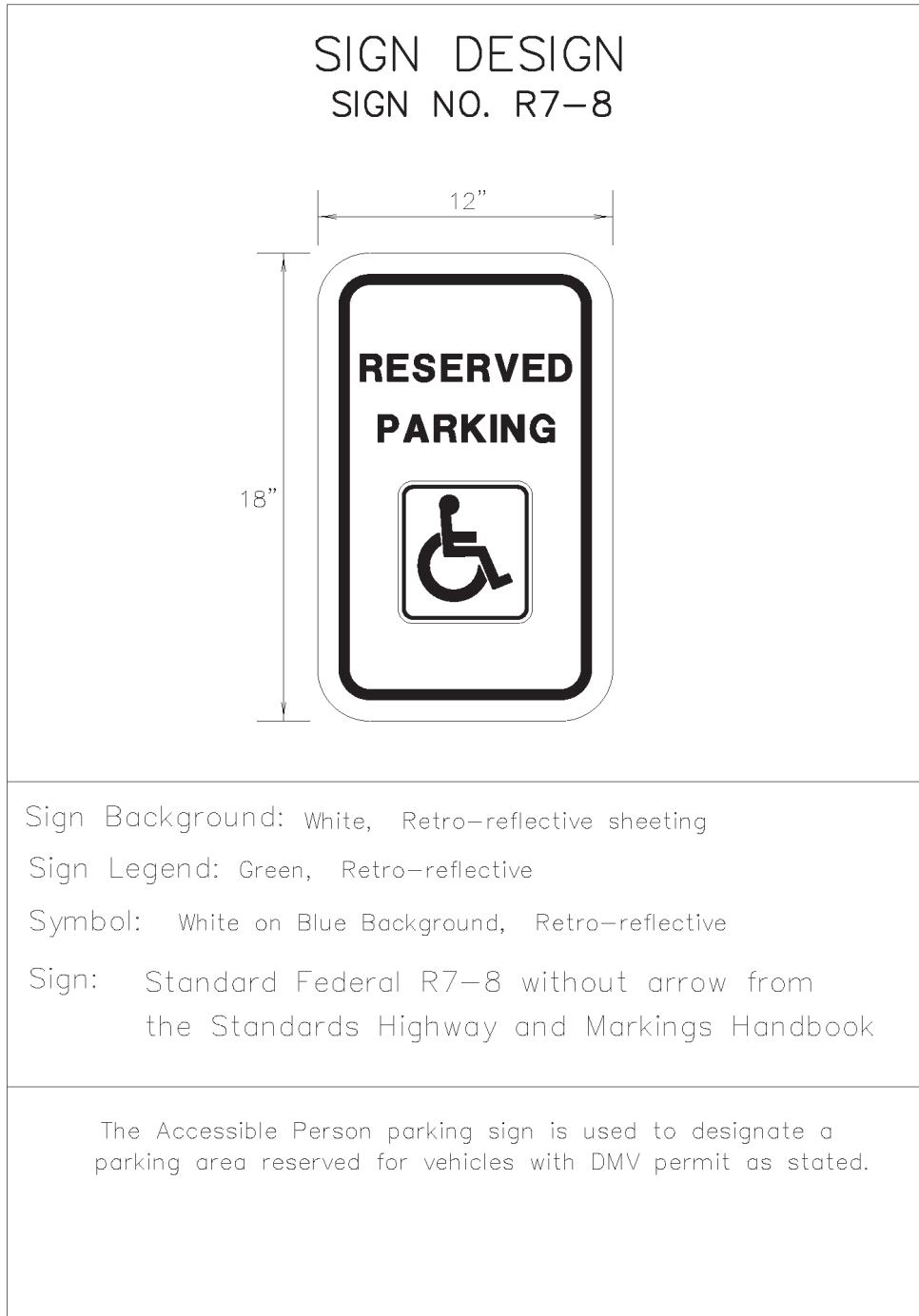

Figure 7

For SI: 1 inch = 25.4 mm.

FIGURE 7

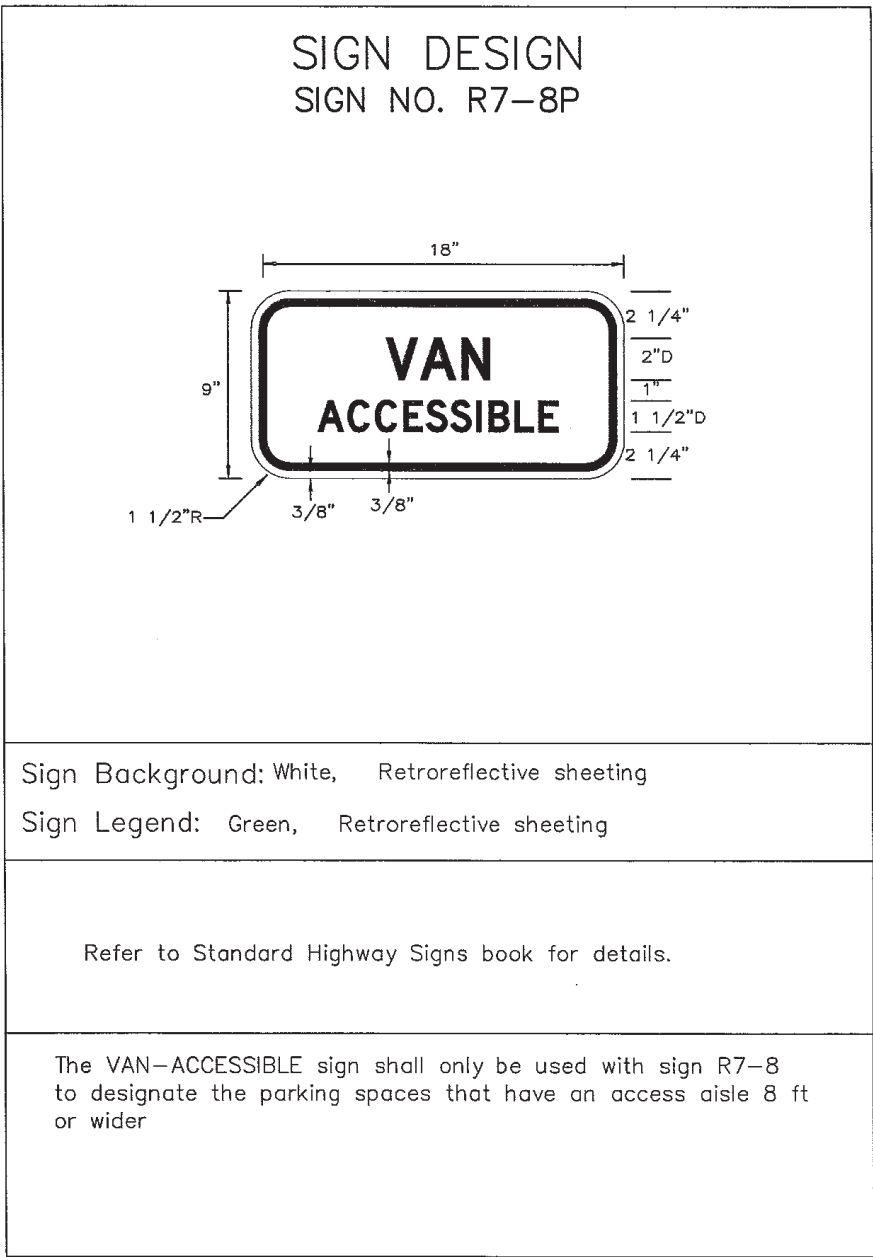

Figure 8

For SI: 1 inch = 25.4 mm, 1 foot = 304.8 mm.

FIGURE 8

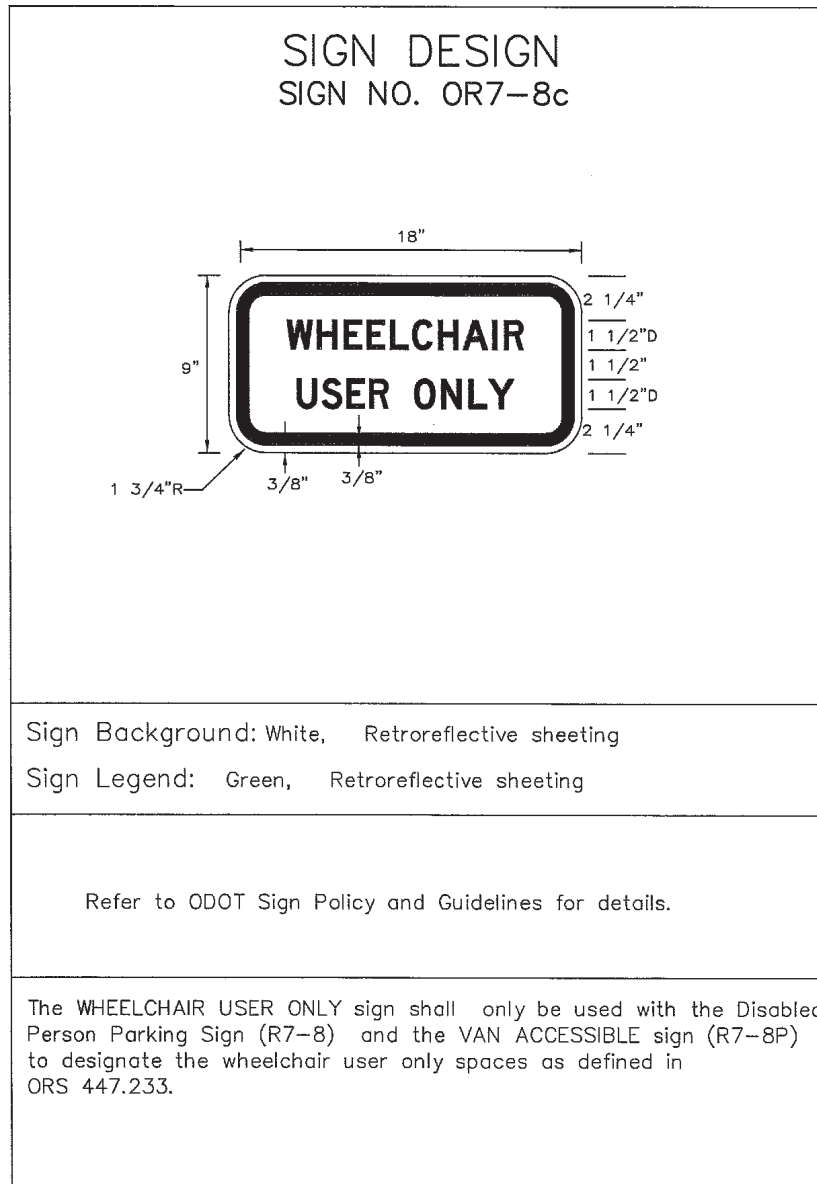
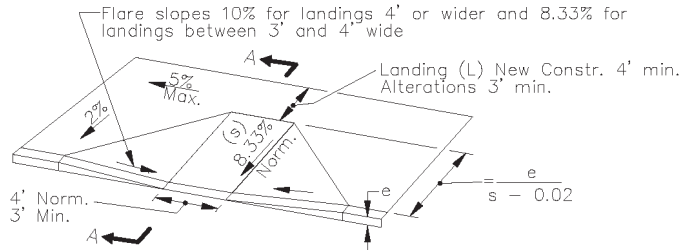

Figure 9

For SI: 1 inch = 25.4 mm, 1 foot = 304.8 mm.

FIGURE 9

ADA RAMP AND SLOPE DESIGN



PERPENDICULAR SIDEWALK RAMP DETAIL

(Use "Parallel or Combined Ramp Detail" when reqd. landing cannot be obtained)

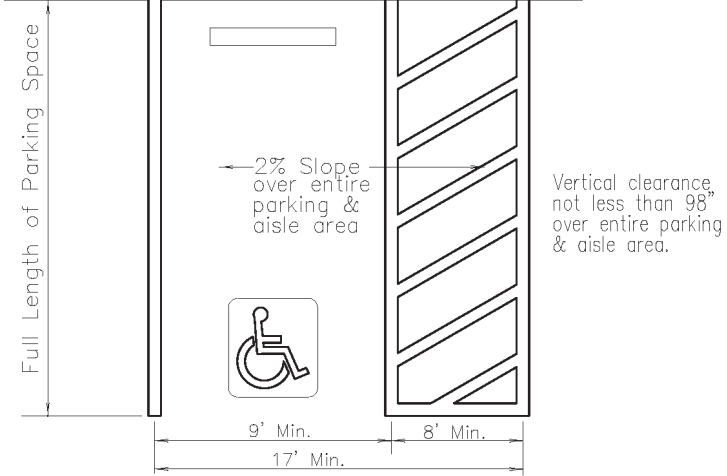
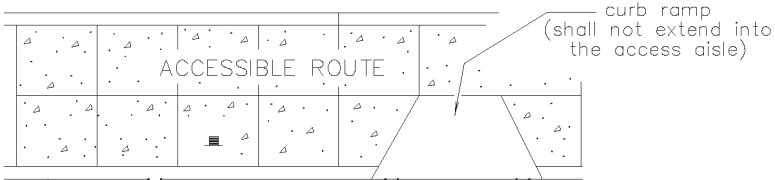
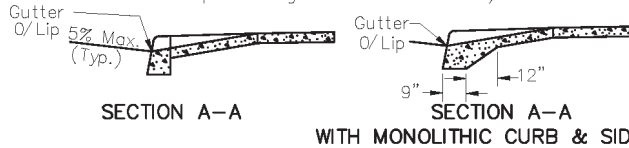

For SI: 1 inch = 25.4 mm, 1 foot = 304.8 mm.

FIGURE 10

*Pages 285 through 334 left intentionally blank.
Text continues on page 335.*